

Matsui Park Hanami Line (June 2024)

This is a 1.98-acre waterfront park, located adjacent to MOSAC and the Sacramento River. The park features blue paver walkway pointing toward Sacramento's sister city, Matsuyama. There are two colors of decomposed granite paving, night lighting, various seating options, shade shelters, Japanese-inspired parasol umbrellas, and over one hundred 'Pink Flair' cherry trees underplanted with turf, low maintenance landscaping with boulders, and cobble swale, custom park signs, a donor wall, and one-of-a-kind tree sculpture. The park is designed for large school groups, community events and family gatherings throughout the changing seasons.

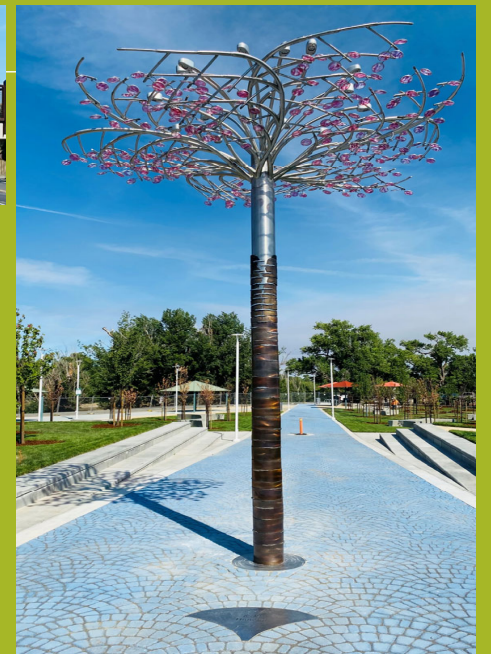

After Restroom exterior

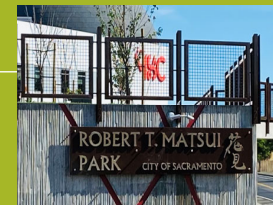
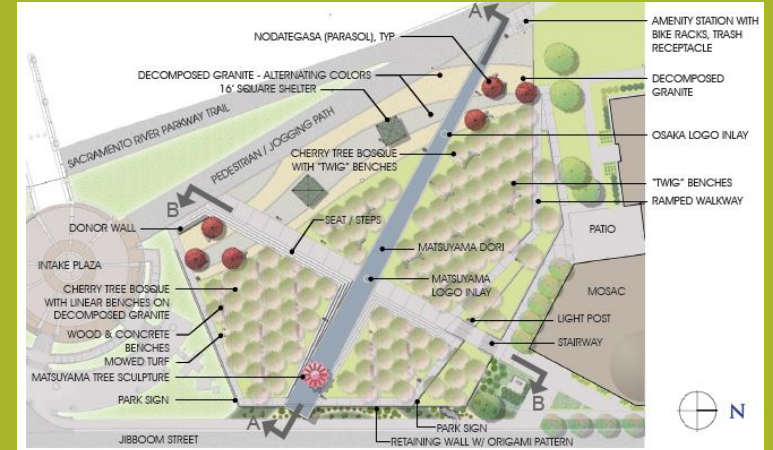

Public Sculpture