

## CITY OF SACRAMENTO STANDARD NOTES

1. ALL CONSTRUCTION SHALL CONFORM TO THE CITY OF SACRAMENTO STANDARD SPECIFICATIONS, DATED JUNE 1989.
2. THE CONTRACTOR SHALL SUBMIT TO THE CITY LANDSCAPE ARCHITECT A REQUEST FOR CONSTRUCTION STAKING TWO (2) WORKING DAYS PRIOR TO NEED FOR PROJECT STAKING.
3. THE CONTRACTOR IS RESPONSIBLE FOR DETERMINING THE EXACT LOCATION OF ALL EXISTING UTILITIES, AND FOR THE PROTECTION OF, AND REPAIR OF DAMAGE TO THEM. THE CONTRACTOR SHALL CONTACT UNDERGROUND SERVICE ALERT (1-800-642-2444) TWO (2) WORKING DAYS BEFORE WORK IS TO BEGIN.
4. THE CONTRACTOR SHALL BE RESPONSIBLE FOR PREPARING AND MAINTAINING AS-BUILT DRAWINGS FOR ALL UNDERGROUND WORK THROUGHOUT THE COURSE OF CONSTRUCTION.
5. THE CONTRACTOR SHALL BE RESPONSIBLE FOR FURNISHING AND MAINTAINING TEMPORARY SIGNS, BARRICADES AND OTHER FACILITIES TO ADEQUATELY SAFEGUARD THE GENERAL PUBLIC AND WORK, AND TO PROVIDE FOR THE PROPER ROUTING OF PEDESTRIAN TRAFFIC. CONSTRUCTION OPERATIONS SHALL COMPLY WITH THE WORK AREA AND TRAFFIC CONTROL HANDBOOK (W.A.T.C.H.).
6. ALL EXISTING TREES SHALL BE PRESERVED, AND SHALL BE FULLY PROTECTED FROM INJURY OR DAMAGE BY THE CONTRACTOR AT HIS EXPENSE. THE CONTRACTOR SHALL NOT ALLOW STACKING OF CONSTRUCTION MATERIALS OR PARKING OF EQUIPMENT AND VEHICLES WITHIN A TREE DRIP LINE.
7. IT IS THE CONTRACTOR'S RESPONSIBILITY TO DETERMINE THE LOCATION OF ANY UNDERGROUND UTILITIES. DAMAGE CAUSED BY THE CONTRACTOR'S INSTALLATION SHALL BE REPAIRED TO THE SATISFACTION OF THE GOVERNING AGENCY AND / OR OWNER. THE CONTRACTOR SHALL BE RESPONSIBLE FOR ALL COSTS OF SUCH REPAIRS.

# CITY OF SACRAMENTO

## DEPARTMENT of PARKS and RECREATION

### LANDSCAPE ARCHITECTURE SECTION

## LANDSCAPE IMPROVEMENT PLANS FOR LONGVIEW OAKS NATURE PRESERVE

### CONTACTS

LANDSCAPE ARCHITECT  
FOOTHILL ASSOCIATES  
2150 PROFESSIONAL DRIVE, SUITE 120  
ROSEVILLE, CA 95661  
(916) 782-1011

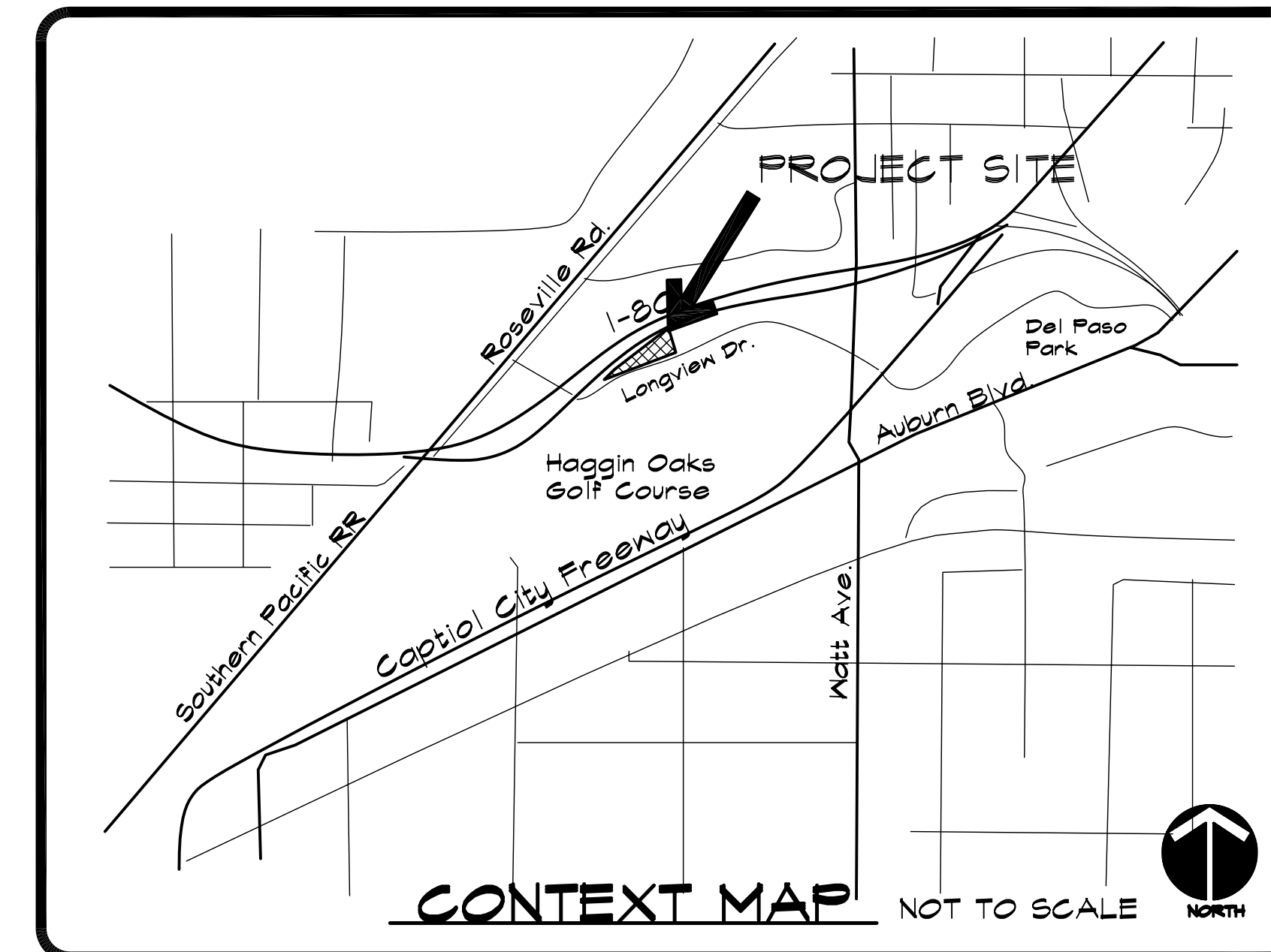

### GENERAL NOTES

1. SPECIFICATIONS: SEE THE GENERAL PROVISIONS, SPECIAL PROVISIONS, GENERAL REQUIREMENTS, AND TECHNICAL SPECIFICATIONS FOR ADDITIONAL INFORMATION AND REQUIREMENTS. TECHNICAL SPECIFICATIONS ARE AN INTEGRAL PART OF THESE DRAWINGS. UPON GIVING A BID PRICE, IT IS ASSUMED THAT THE CONTRACTOR HAS READ AND UNDERSTOOD ALL INFORMATION CONTAINED THEREIN.
2. UNAUTHORIZED CHANGES AND USES: FOOTHILL ASSOCIATES WILL NOT BE RESPONSIBLE FOR, OR LIABLE FOR, UNAUTHORIZED CHANGES TO OR USES OF THESE PLANS. ALL CHANGES TO THE PLANS MUST BE IN WRITING AND MUST BE APPROVED BY FOOTHILL ASSOCIATES.
3. BASE SHEET DATA: THE PROPOSED IMPROVEMENTS SHOWN ON THESE DRAWINGS ARE DRAWN ONTO A BASE SHEET FORMED FROM THE TOPOGRAPHIC SURVEY, ARCHITECTURAL AND/OR ENGINEERING DOCUMENTS, AND OTHER DATA THAT HAS BEEN MADE AVAILABLE TO FOOTHILL ASSOCIATES. FOOTHILL ASSOCIATES SHALL NOT BE HELD LIABLE FOR CHANGES, INACCURACIES, OMISSIONS, OR OTHER ERRORS ON DOCUMENTS PROVIDED TO US. THE BASE SHEET DATA IS PROVIDED AS AN AID ONLY AND THE CONTRACTOR SHALL BE RESPONSIBLE FOR REVIEWING THESE DOCUMENTS AND INCORPORATING/INTEGRATING ALL CONSTRUCTION AS REQUIRED TO ACCOMMODATE SAME.
4. CONTRACTOR: ALL WORK IS TO BE PERFORMED BY A LICENSED CONTRACTOR AND EXPERIENCED WORKERS. THE CONTRACTOR SHALL CONFORM TO ALL LOCAL CODES AND OBTAIN AND PAY FOR ALL PERMITS NECESSARY TO COMPLETE THE WORK, EXCEPT WATER QUALITY CERTIFICATION AND STREAMBED ALTERATION AGREEMENT.
5. JOB SITE CONDITIONS: THE CONTRACTOR AGREES THAT IN ACCORDANCE WITH GENERALLY ACCEPTED CONSTRUCTION PRACTICES THAT THE CONTRACTOR WILL BE REQUIRED TO ASSUME SOLE AND COMPLETE RESPONSIBILITY FOR JOB SITE CONDITIONS DURING THE COURSE OF CONSTRUCTION OF THE PROJECT, INCLUDING SAFETY OF ALL PERSONS AND PROPERTY; THAT THIS REQUIREMENT SHALL BE MADE TO APPLY CONTINUOUSLY AND NOT BE LIMITED TO NORMAL WORKING HOURS. THE CONTRACTOR FURTHER AGREES TO DEFEND, INDEMNIFY, AND HOLD THE OWNER AND FOOTHILL ASSOCIATES HARMLESS FROM ANY AND ALL LIABILITY, REAL OR ALLEGED IN CONNECTION WITH THE PERFORMANCE OF WORK ON THIS PROJECT EXCEPT LIABILITY ARISING FROM THE SOLE NEGLIGENCE OF THE OWNER OR FOOTHILL ASSOCIATES.
6. COORDINATION: THE CONTRACTOR SHALL BE RESPONSIBLE FOR COORDINATING THE SCHEDULING OF CONSTRUCTION OPERATIONS WITH CONSTRUCTION OPERATIONS OF OTHERS WORKING ON OR NEAR THE PROJECT SITE.
7. EMISSIONS: THE CONTRACTOR SHALL MAINTAIN AND OPERATE CONSTRUCTION EQUIPMENT TO MINIMIZE EXHAUST EMISSIONS. DURING CONSTRUCTION, TRUCKS AND EQUIPMENT SHALL BE OPERATED ONLY WHEN NECESSARY AND ENGINES SHALL BE SHUT OFF WHEN TRUCKS ARE BEING LOADED OR UNLOADED OR OTHERWISE STATIONARY. EQUIPMENT SHALL BE MAINTAINED IN GOOD CONDITION AND WELL-TUNED TO MINIMIZE EXHAUST EMISSIONS.

### SHEET INDEX

Title	Sheet No.
COVER SHEET	1
PLANTING AND TREE PROTECTION PLAN	2
LAYOUT PLAN	3
GRADING PLAN	4
GRADING DETAILS	5
VERNAL POOL DETAILS	6

Dennis Day, Senior Landscape Architect, CLA#4386  
Department of Parks and Recreation

Kathleen M. Kirsh, Landscape Architect, CLA #4362  
Foothill Associates



### LOCATION MAP

NOT TO SCALE



CITY OF SACRAMENTO  
PARKS AND RECREATION DEPARTMENT  
LANDSCAPE ARCHITECTURE SECTION  
1023 J STREET, ROOM 200, SACRAMENTO, CA 95814

LONGVIEW OAKS  
VERNAL POOL NATURE PRESERVE-PHASE I  
COVER SHEET

LANDSCAPE ARCHITECT:  
KATE KIRSH  
LIC. NO. 4362

DESIGNED BY:  
ETA

DRAWN BY:  
ETA, MMB

CAD DWG:  
Longview\_PHASEI.dwg

DATE 4/16/2008

SCALE: NTS

P. N.:

REVISIONS

SHEET NO.

1

OF 6

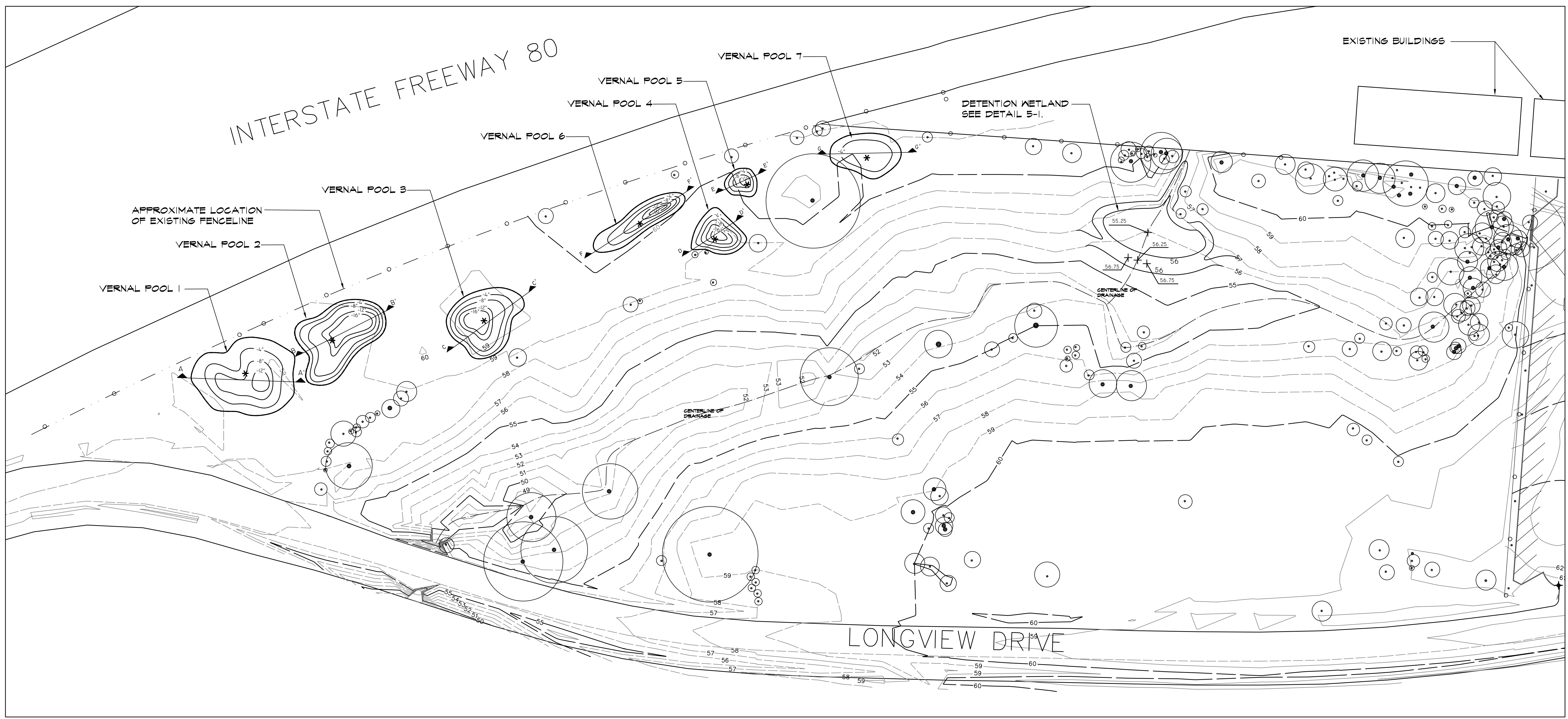

VERNAL POOL	SOIL TYPE	DEPTH TO CLAYPAN	CLAYPAN THICKNESS	DEPTH TO HARDPAN	RECOMMENDED CUT
VP-1	SAN JOAQUIN	15"	12"	27"	12"
VP-2	SAN JOAQUIN	19"	8"	27"	16"
VP-3	SAN JOAQUIN	19"	9"	28"	16"
VP-4	SAN JOAQUIN	21"	8"	29"	17"
VP-5	SAN JOAQUIN	24"	7"	31"	12"
VP-6	SAN JOAQUIN	19"	6"	25"	16"
VP-7	SAN JOAQUIN	6"	8"	14"	6"

DATA FROM SOIL TEST PIT AT LOCATION MARKED WITH \*  
 FOR VERNAL POOL SECTIONS AND DETAILS:  
 SEE PAGE 6.  
 VERNAL POOL INOCULATION: SEE DETAIL 6-1.

**GRADING NOTES**

- SEE TECHNICAL SPECIFICATIONS AND GENERAL NOTES FOR ADDITIONAL INFORMATION INCLUDING UTILITIES VERIFICATION PROTECTION AND RESTORATION INFORMATION AND REQUIREMENTS.
- BEFORE BEGINNING WORK CONTRACTOR WILL WALK SITE LOOKING FOR BEE NEST HOLES. IF FOUND, THESE SITES ARE TO BE AVOIDED IF POSSIBLE.
- ALL EXISTING TREES, INCLUDING SEEDLINGS PLANTED NOVEMBER 2002, SHALL BE PROTECTED FROM DAMAGE OR INJURY DURING CONSTRUCTION. TREE PROTECTION ZONES AS SHOWN ON THE PLANS SHALL BE DELINEATED ON SITE WITH ORANGE PLASTIC FENCING. FENCING SHALL BE PLACED A MINIMUM OF FIVE FEET FROM SEEDLINGS IN SEEDLING PLANTING AREAS. NO PARKING OR STACKING OF MATERIALS IS ALLOWED WITHIN THE DRIP LINE OF EXISTING TREES. NO PRUNING OF TREES IS ALLOWED WITHOUT PRIOR CONSULTATION WITH THE LANDSCAPE ARCHITECT AND ARBORIST.
- PRIOR TO CONSTRUCTION, CONTRACTOR WILL STAKE SPOIL ZONES AND ACCESS ROUTES AND LANDSCAPE ARCHITECT WILL CONFIRM BOUNDARIES.
- STOCKPILED SOIL AND MATERIALS SHALL BE KEPT IN THE SPOIL ZONE. VEHICULAR TRAFFIC SHALL BE LIMITED TO THE ACCESS ROUTES AND GRADED AREAS.
- MAINTAIN MAXIMUM 3:1 SLOPE ON ALL CUT/FILL.
- GRADING IN FIELD FOR VERNAL POOLS WILL BE SUPERVISED BY VERNAL POOL SOIL SPECIALIST AND FINE-TUNED TO ENSURE PROPER DEPTH OF POOL AND RELATIONSHIP TO CLAY LAYER.
- EXCESS SOIL FROM VERNAL POOL CUT SHALL BE USED TO REGRADE EXCAVATION FROM ROAD REMOVAL TO BLEND WITH SURROUNDING GRADES OR TO FORM THE BERM ON THE DETENTION WETLAND PER DIRECTION FROM LANDSCAPE ARCHITECT. ANY EXCESS FILL LEFT OVER WILL BE SPOILED ON SITE.
- INTENT OF PLAN IS FOR NO NET IMPORT OR EXPORT OF FILL. THIS DOES NOT INCLUDE VERNAL POOL INOCULATION MATERIAL.
- UNDER NO CIRCUMSTANCES WILL ANY HEAVY EQUIPMENT BE MOVED ACROSS EXISTING DRAINAGES ONTO THE SOUTH OR EAST SECTIONS OF THE SITE.
- ALL DISTURBED AREAS OUTSIDE OF THE VERNAL POOLS AND DETENTION WETLAND SHALL BE HYDROSEEDING WITH THE FOLLOWING MIX: GOLDEN STATE NATIVE GRASS EROSION MIX, AVAILABLE FROM LARNER SEEDS (415) 868-9407.

**LEGEND**

- APPROXIMATE VERNAL POOL PERIMETER
- EXISTING TREE TO REMAIN

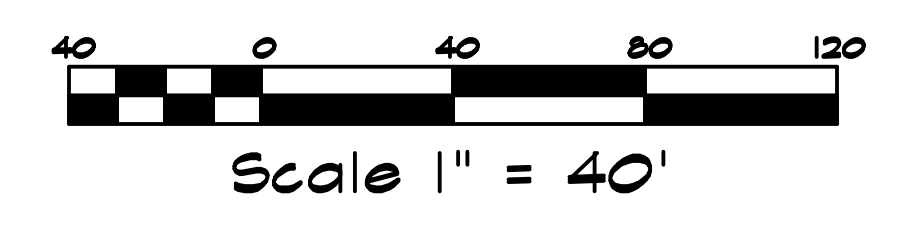

LANDSCAPE ARCHITECT:  
 KATE KIRSH  
 LIC. NO. 4362  
 DESIGNED BY:  
 ETA  
 DRAWN BY:  
 ETA, MMB  
 CAD DWG:  
 longview\_PHASEI.dwg  
 DATE 4/16/2003  
 SCALE AS SHOWN  
 P. N. :  
 REVISIONS

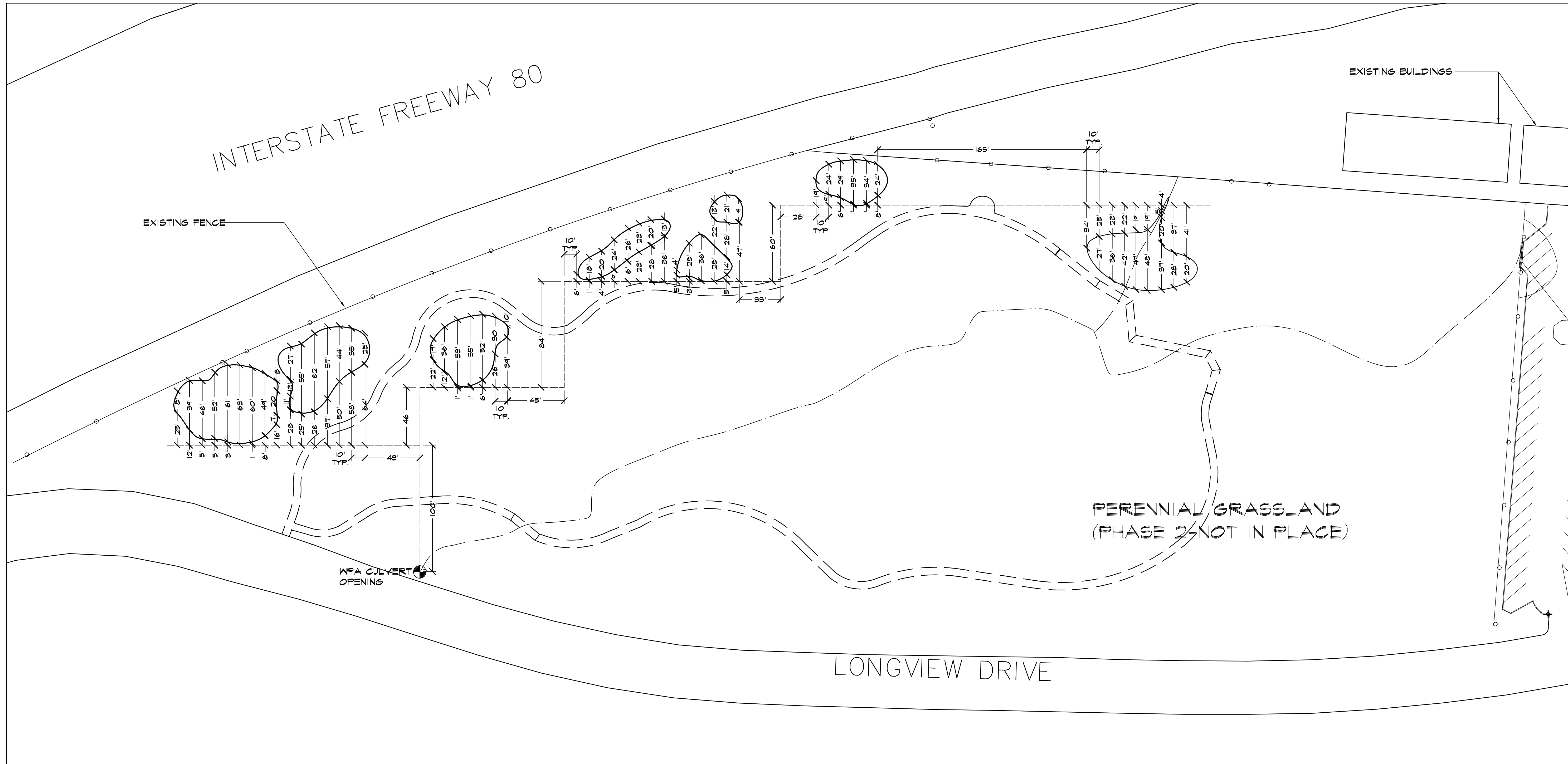

### LAYOUT AND CONSTRUCTION NOTES

1. **CONTRACTOR:** ALL WORK IS TO BE PERFORMED BY A LICENSED CONTRACTOR AND EXPERIENCED WORKERS.
2. **SPECIFICATIONS:** SEE TECHNICAL SPECIFICATIONS AND GENERAL NOTES FOR ADDITIONAL INFORMATION INCLUDING UTILITIES VERIFICATION PROTECTION, AND RESTORATION INFORMATION AND REQUIREMENTS.
3. **DIMENSIONS:** ALL WRITTEN DIMENSIONS SUPERSEDE SCALED DIMENSIONS.
4. **LAYOUT:** THE CONTRACTOR IS RESPONSIBLE FOR ALL CONSTRUCTION STAKING. THE CONTRACTOR SHALL CONTACT THE LANDSCAPE ARCHITECT FOR CLARIFICATION OF ANY DISCREPANCIES BETWEEN FIELD CONDITIONS AND PLANS PRIOR TO PROCEEDING WITH WORK. ALL FIELD ADJUSTMENTS MUST BE APPROVED BY THE LANDSCAPE ARCHITECT PRIOR TO INSTALLATION.
5. **VERNAL POOLS:** VERNAL POOLS AND DETENTION BASIN TO BE STAKED IN FIELD BY CONTRACTOR AND CHECKED BY LANDSCAPE ARCHITECT PRIOR TO CONSTRUCTION.

6. **SOIL COMPACTION:** COMPACT ALL FILL AREAS 85% IN LIFTS OF 12 INCH MAXIMUM, EXCEPT UPPER 12 INCHES OF ALL PLANTING AREAS. SEE SPECIFICATIONS.

7. **EROSION CONTROL:** THE CONTRACTOR IS RESPONSIBLE FOR SOIL EROSION CONTROL MEASURES THAT MAY BE REQUIRED THROUGH THE DURATION OF THE CONTRACT PERIOD. SHOULD SOIL EROSION CONDITIONS EXIST THAT REQUIRE MITIGATION WHEN THE CONTRACTOR INITIALLY ACCEPTS THE SITE, THE LANDSCAPE ARCHITECT OR OWNER SHALL BE ALERTED. FAILURE OF THE CONTRACTOR TO NOTIFY THE LANDSCAPE ARCHITECT OR THE OWNER IMPLIES ACCEPTANCE OF THE SITE BY THE CONTRACTOR IN ITS EXISTING CONDITION. ALL COSTS NECESSARY TO MITIGATE EXISTING EROSION PROBLEMS SHALL BE AT THE CONTRACTOR'S EXPENSE AND AT NO ADDITIONAL COST TO THE OWNER OR LANDSCAPE ARCHITECT.

### LEGEND

- ORIGIN (0,0)
- BASELINE
- VERNAL POOL BOUNDARY
- PHASE 2 PATH ALIGNMENT (SHOWN FOR INFORMATIONAL USE ONLY)

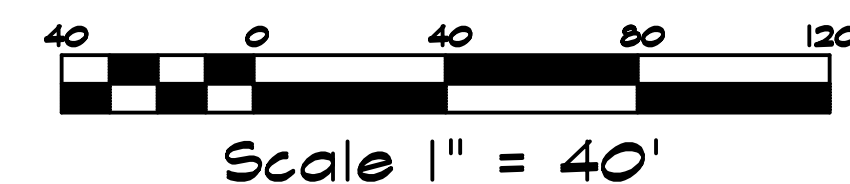
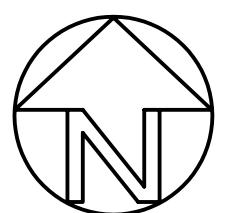

**CITY OF SACRAMENTO**  
 PARKS AND RECREATION DEPARTMENT  
 LANDSCAPE ARCHITECTURE SECTION  
 1028 J STREET, ROOM 200, SACRAMENTO, CA 95814

**LONGVIEW OAKS**  
 VERNAL POOL NATURE PRESERVE-PHASE I  
 LAYOUT

LANDSCAPE ARCHITECT:  
 KATE KIRSH  
 LIC. NO. 4362  
 DESIGNED BY:  
 ETA  
 DRAWN BY:  
 ETA, MMB  
 CAD DWG:  
 longview\_PHASE1.dwg

DATE 4/16/2008

SCALE AS SHOWN

P. N.:

REVISIONS

SHEET NO.

3

OF 6

INTERSTATE FREEWAY 80

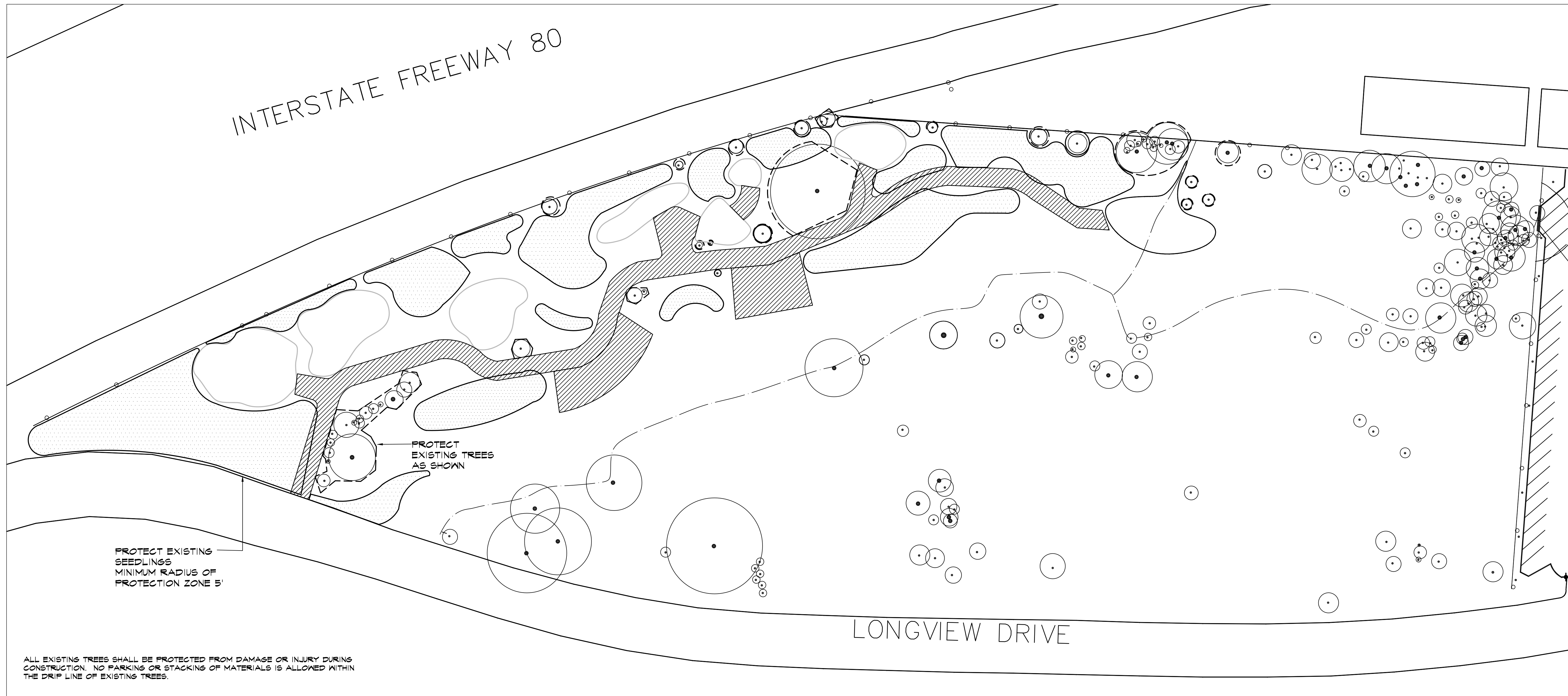

PROTECT EXISTING TREES AS SHOWN

PROTECT EXISTING SEEDLINGS  
MINIMUM RADIUS OF PROTECTION ZONE 5'

ALL EXISTING TREES SHALL BE PROTECTED FROM DAMAGE OR INJURY DURING CONSTRUCTION. NO PARKING OR STACKING OF MATERIALS IS ALLOWED WITHIN THE DRIP LINE OF EXISTING TREES.

LONGVIEW DRIVE

**STREAMBED ALTERATION AGREEMENT NOTES**

- A. A COPY OF THE STREAMBED ALTERATION AGREEMENT SHALL BE PROVIDED TO, AND SIGNED BY, THE CONTRACTOR PRIOR TO THE START OF CONSTRUCTION. A COPY OF THE AGREEMENT SHALL BE AVAILABLE ON SITE AT ALL TIMES.
- B. CONSTRUCTION ACTIVITIES SHALL BE LIMITED TO PERIODS OF LOW STREAM FLOW BETWEEN APRIL 1, 2003 AND OCTOBER 31, 2003. CONSTRUCTION ACTIVITIES SHALL CEASE AND ALL REASONABLE EROSION CONTROL MEASURES SHALL BE IMPLEMENTED PRIOR TO ALL STORM EVENTS.
- C. IF CONSTRUCTION, GRADING, OR OTHER PROJECT RELATED IMPROVEMENTS ARE SCHEDULED BETWEEN FEBRUARY 1, 2003 AND AUGUST 31, 2003 A FOCUSED SURVEY FOR ACTIVE RAPTOR NESTS WILL BE CONDUCTED BY A QUALIFIED BIOLOGIST WITHIN 15 DAYS PRIOR TO THE BEGINNING OF PROJECT RELATED ACTIVITIES. CONTACT FOOTHILL ASSOCIATES FOR BIOLOGICAL SURVEY.
- D. THE CONTRACTOR WILL NOTIFY FOOTHILL ASSOCIATES, WHO WILL NOTIFY THE DEPARTMENT OF FISH AND GAME, WITHIN TWO WORKING DAYS OF BEGINNING WORK IN THE STREAM ZONE.
- E. THE CONTRACTOR OR A DESIGNATED CREW SUPERVISOR SHALL BE ON SITE THE ENTIRE TIME A WORK CREW IS WORKING NEAR THE STREAM ZONE.
- F. THE CONTRACTOR SHALL NOTIFY FOOTHILL ASSOCIATES, WHO WILL NOTIFY THE DEPARTMENT OF FISH AND GAME, WITHIN TWO WORKING DAYS OF THE COMPLETION OF WORK WITHIN THE STREAM ZONE.
- G. OIL OR OTHER PETROLEUM PRODUCTS, OR ANY OTHER SUBSTANCES THAT COULD BE HAZARDOUS TO AQUATIC LIFE, RESULTING FROM PROJECT RELATED ACTIVITIES SHALL BE PREVENTED FROM CONTAMINATING THE SOIL AND/OR ENTERING THE WATERS OF THE STREAM. THE DEPARTMENT OF FISH AND GAME SHALL BE NOTIFIED IMMEDIATELY OF ANY SPILLS AND SHALL BE CONSULTED REGARDING CLEAN-UP PROCEDURES.
- H. DURING CONSTRUCTION, THE CONTRACTOR SHALL NOT DUMP ANY LITTER OR CONSTRUCTION DEBRIS WITHIN THE STREAM ZONE. ALL CONSTRUCTION DEBRIS AND ASSOCIATED MATERIALS, SUCH AS TEMPORARY CONSTRUCTION FENCES, BARRIERS, AND/OR FLAGGING, SHALL BE REMOVED UPON THE COMPLETION OF THE PROJECT.
- I. ALL DISTURBED AREAS LEFT BARREN OF VEGETATION AS A RESULT OF CONSTRUCTION ACTIVITIES WILL BE RESEEDED ACCORDING TO THE SPECIFICATIONS AND PROJECT PLANS. REVEGETATION IS NOT CONFINED TO THE TIME PERIOD OF APRIL 1, 2003 TO OCTOBER 1, 2003.

**PLANTING NOTES**

- 1. SPECIFICATIONS: SEE TECHNICAL SPECIFICATIONS AND GENERAL NOTES FOR ADDITIONAL INFORMATION INCLUDING UTILITIES VERIFICATION PROTECTION, AND RESTORATION INFORMATION AND REQUIREMENTS.
- 2. EXISTING PLANT MATERIAL: PROTECT ALL EXISTING TREES AND PLANT MATERIAL TO REMAIN. CONTRACTOR TO REPAIR AT NO ADDITIONAL COST ANY DAMAGES INCURRED AS A RESULT OF THIS CONTRACT TO THE OWNER'S SATISFACTION.
- 3. PLANTING: ALL TREE AND WETLAND PLANTING SHALL BE DONE BY VOLUNTEERS. CONTRACTOR SHALL BE RESPONSIBLE FOR HYDROSEEDING DISTURBED AREAS. MAINTENANCE WILL BE PROVIDED BY VOLUNTEERS AND THE CITY OF SACRAMENTO PARK MAINTENANCE STAFF. THESE PLANS ARE PROVIDED TO THE CONTRACTOR FOR INFORMATIONAL PURPOSES ONLY.
- 4. DISTURBED AREAS: ALL DISTURBED AREAS OUTSIDE OF THE VERNAL POOLS AND DETENTION WETLAND SHALL BE HYDROSEEDED WITH THE FOLLOWING MIX: GOLDEN STATE NATIVE GRASS EROSION MIX, AVAILABLE FROM LARNER SEEDS (415) 868-9407.
- 5. DETENTION WETLAND: THE CONTRACTOR WILL HYDROSEED THE DETENTION WETLAND WITH THE FOLLOWING MIX: BASIC RIPARIAN MIX, AVAILABLE FROM S&S SEEDS, (805) 684-2798.
- 6. TIMING: ALL PLANTINGS SHALL BE MADE IN THE LATE FALL OR EARLY WINTER TO PERMIT PLANT ESTABLISHMENT IN THE COOL MONTHS AND MAXIMIZE SURVIVAL OF THE PLANTINGS.

**PLANTING AND TREE PROTECTION LEGEND**

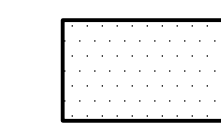
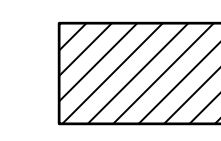
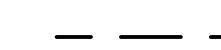
-  SEEDLING PLANTING AREA
-  HAUL ROUTE AND SPOIL ZONES
-  TREE PROTECTION FENCING



**CITY OF SACRAMENTO**  
PARKS AND RECREATION DEPARTMENT  
LANDSCAPE ARCHITECTURE SECTION  
1028 J STREET, ROOM 200, SACRAMENTO, CA 95814

**LONGVIEW OAKS**  
VERNAL POOL NATURE PRESERVE-PHASE I  
PLANTING AND TREE PROTECTION

LANDSCAPE ARCHITECT:  
KATE KIRSH  
LIC. NO. 4362  
DESIGNED BY:  
ETA  
DRAWN BY:  
ETA, MMB  
CAD DWG:  
longview\_PHASEI.dwg  
DATE 4/16/2003  
SCALE AS SHOWN  
P. N. :  
REVISIONS

SHEET NO.  
**2**  
OF 6

LONGVIEW OAKS PRESERVE

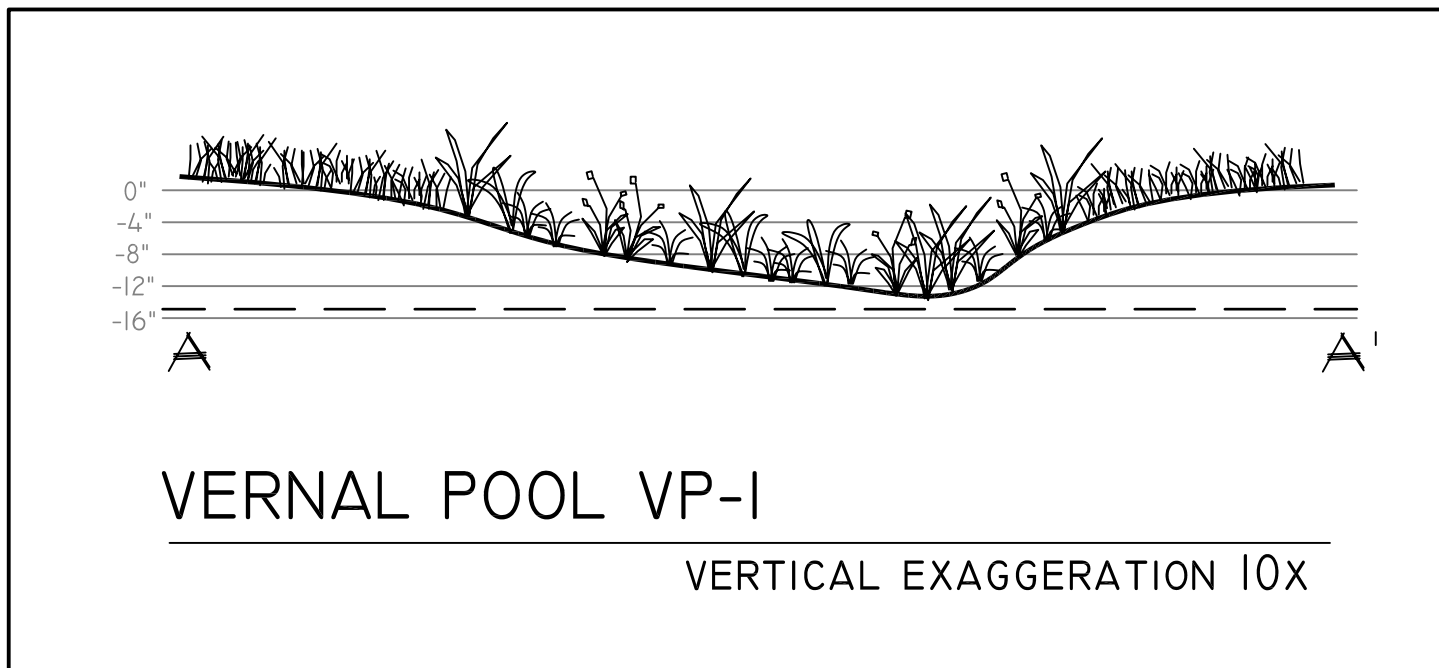

1"=20'

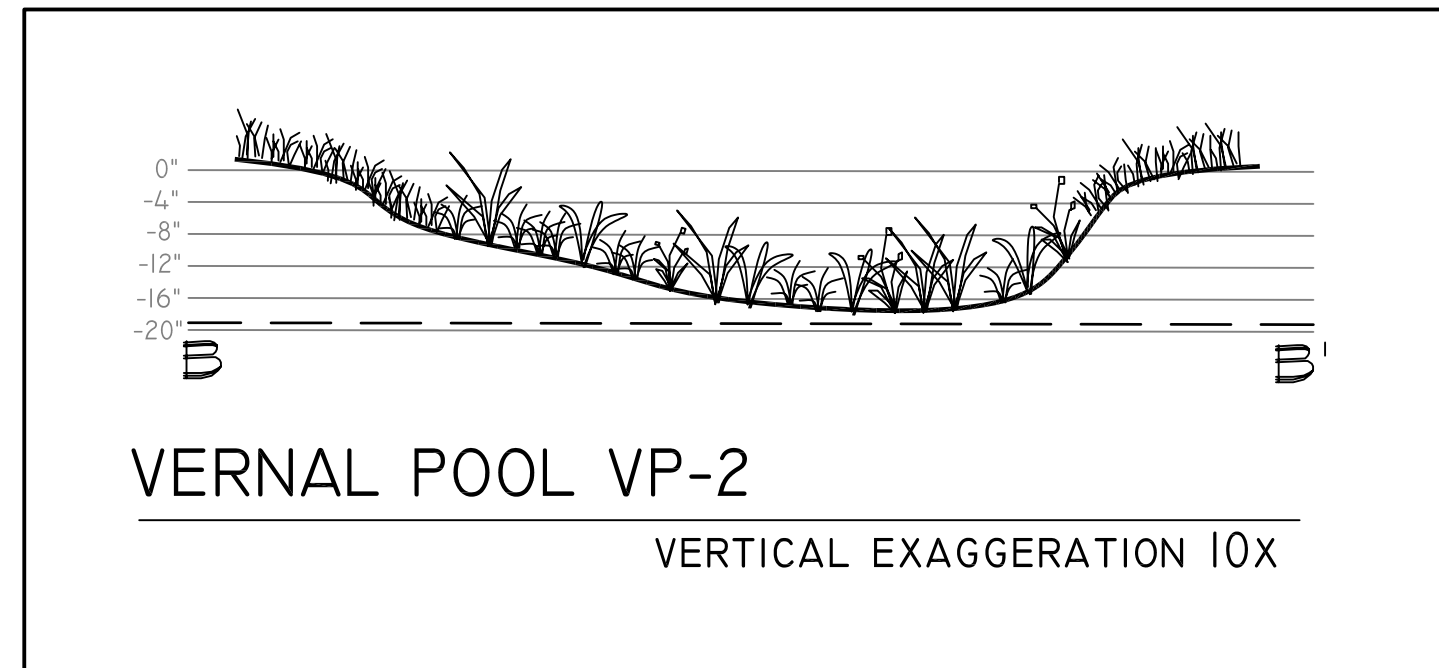

1"=20'

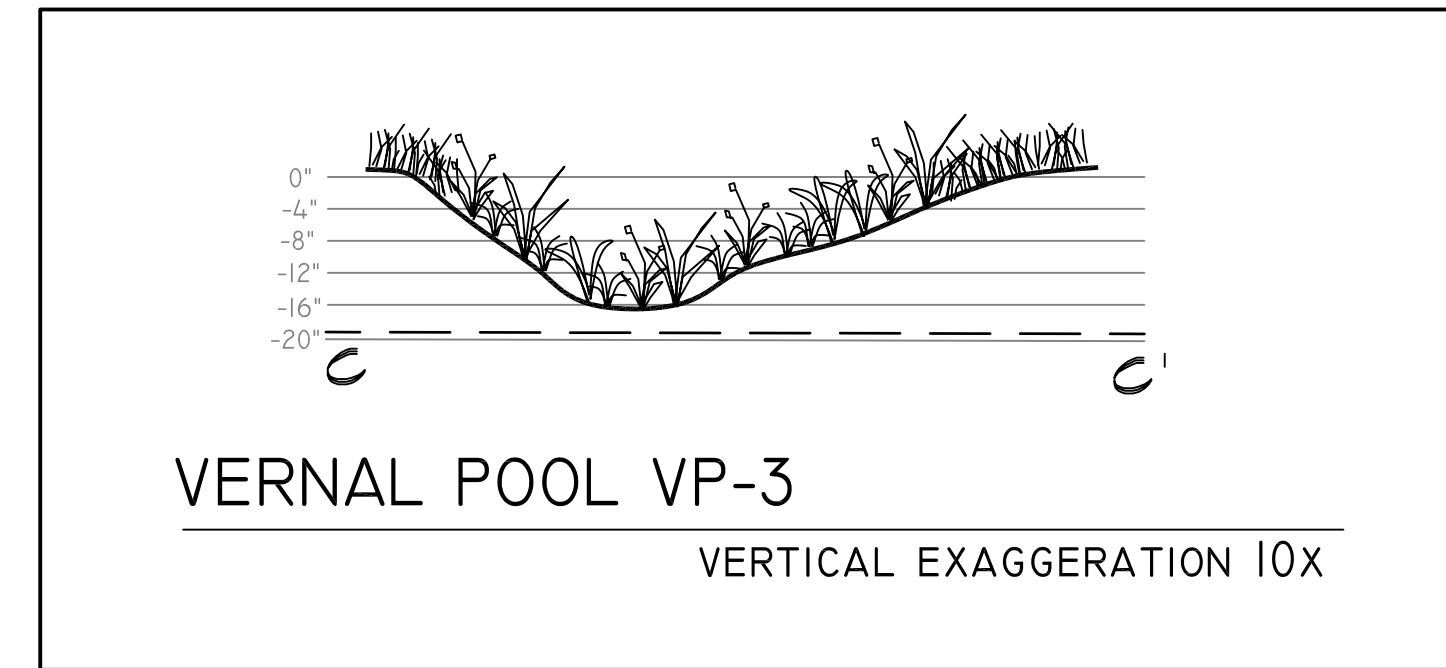

1"=20'

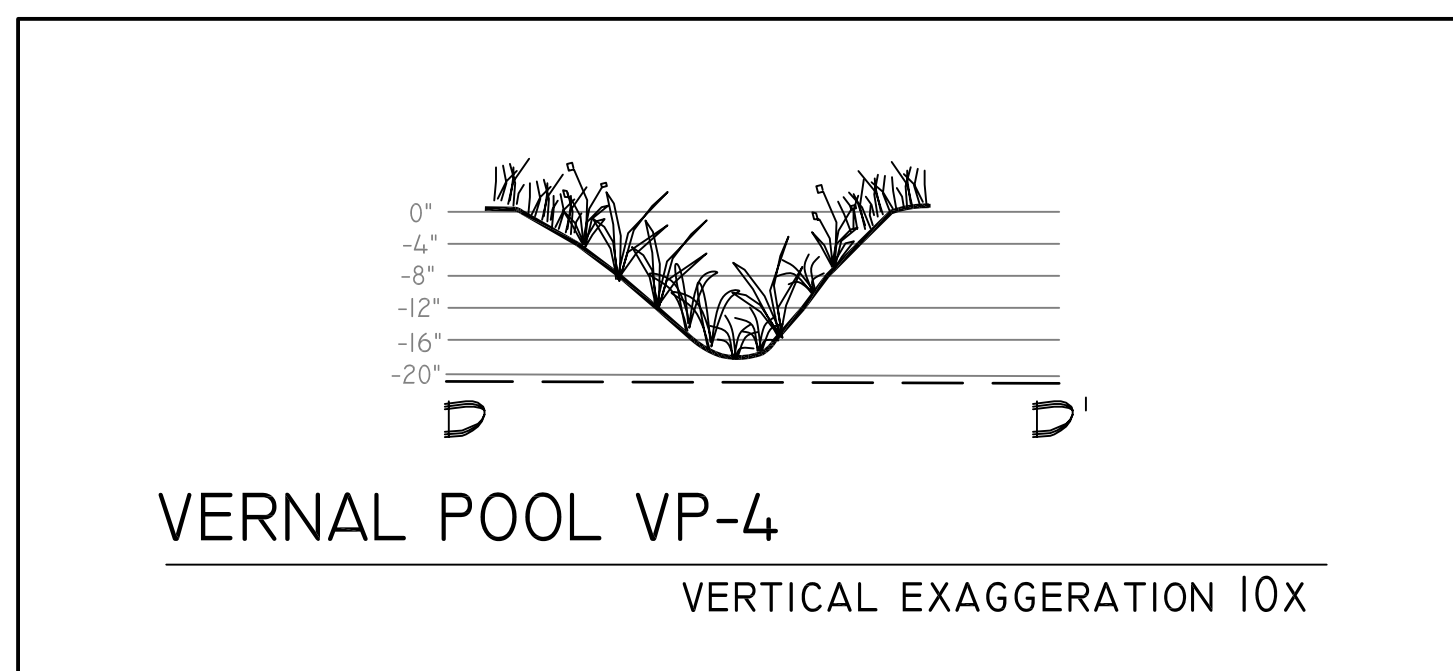

1"=20'

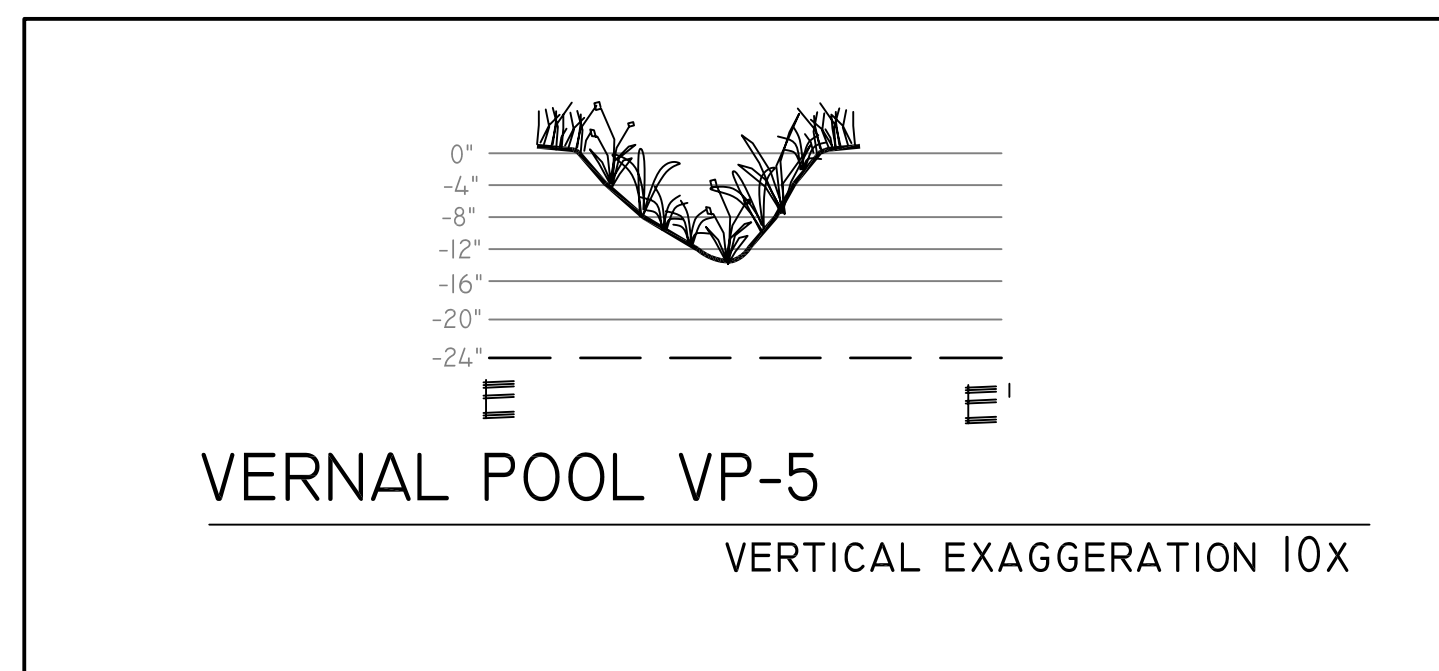

1"=20'

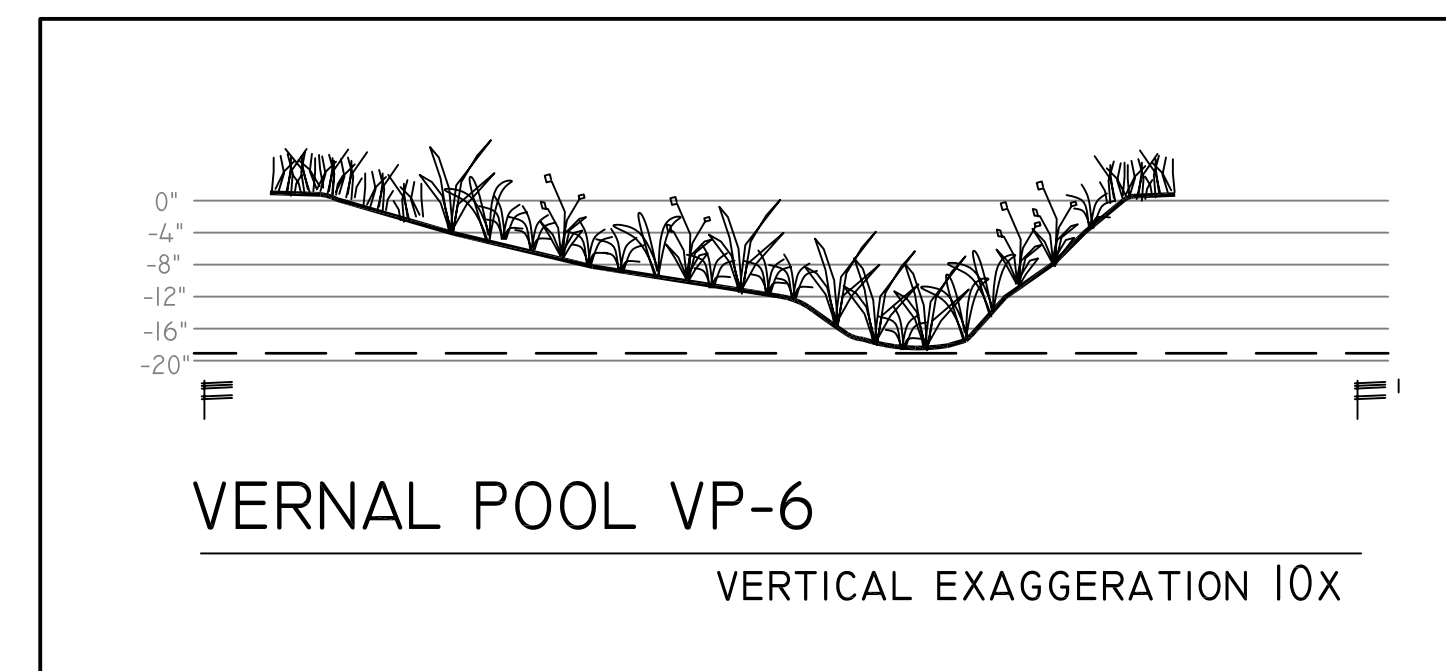

1"=20'

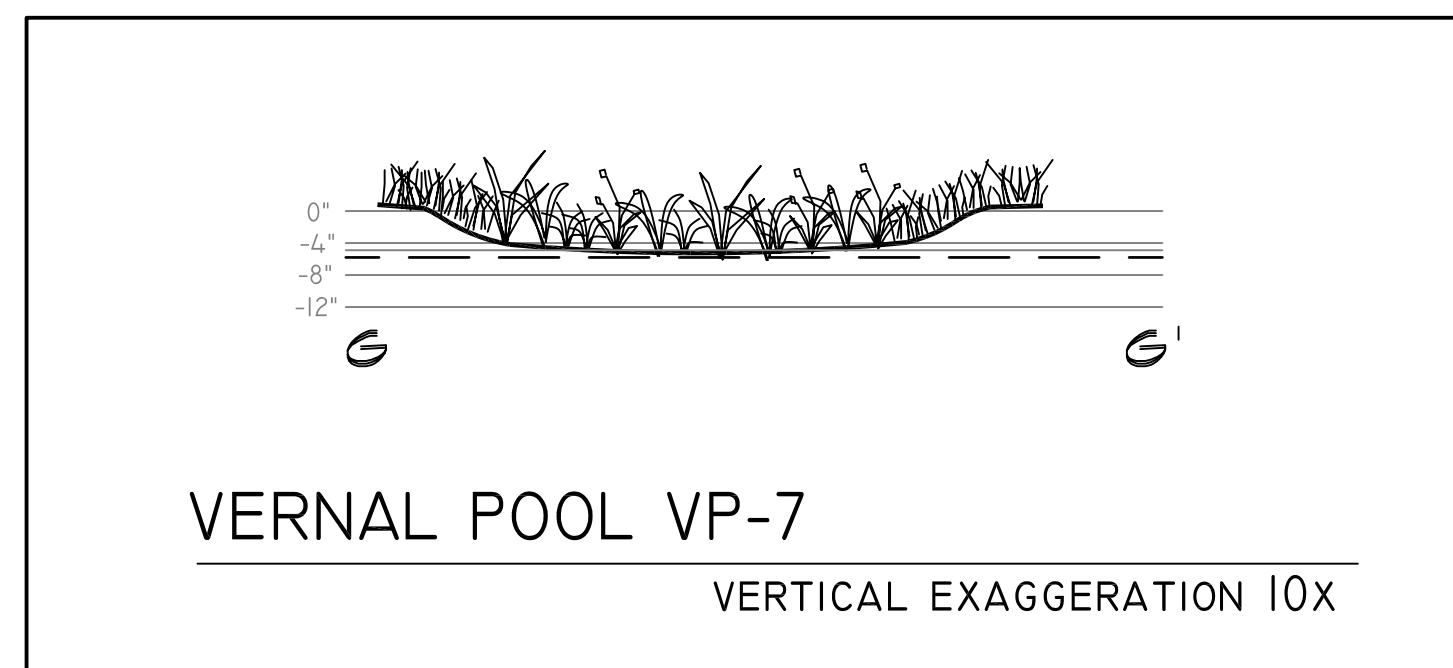

1"=20'

LEGEND

----- CLAYPAN

VERNAL POOL GRADING EXAMPLES SHOWING INTENT OF TERRACING AND SLOPE VARIATIONS AND CHARACTER OF POOLS.

ADJUSTMENTS IN FIELD DURING CONSTRUCTION WILL BE COORDINATED BY LANDSCAPE ARCHITECT AND FOOTHILL ASSOCIATES' SOIL SCIENTIST.

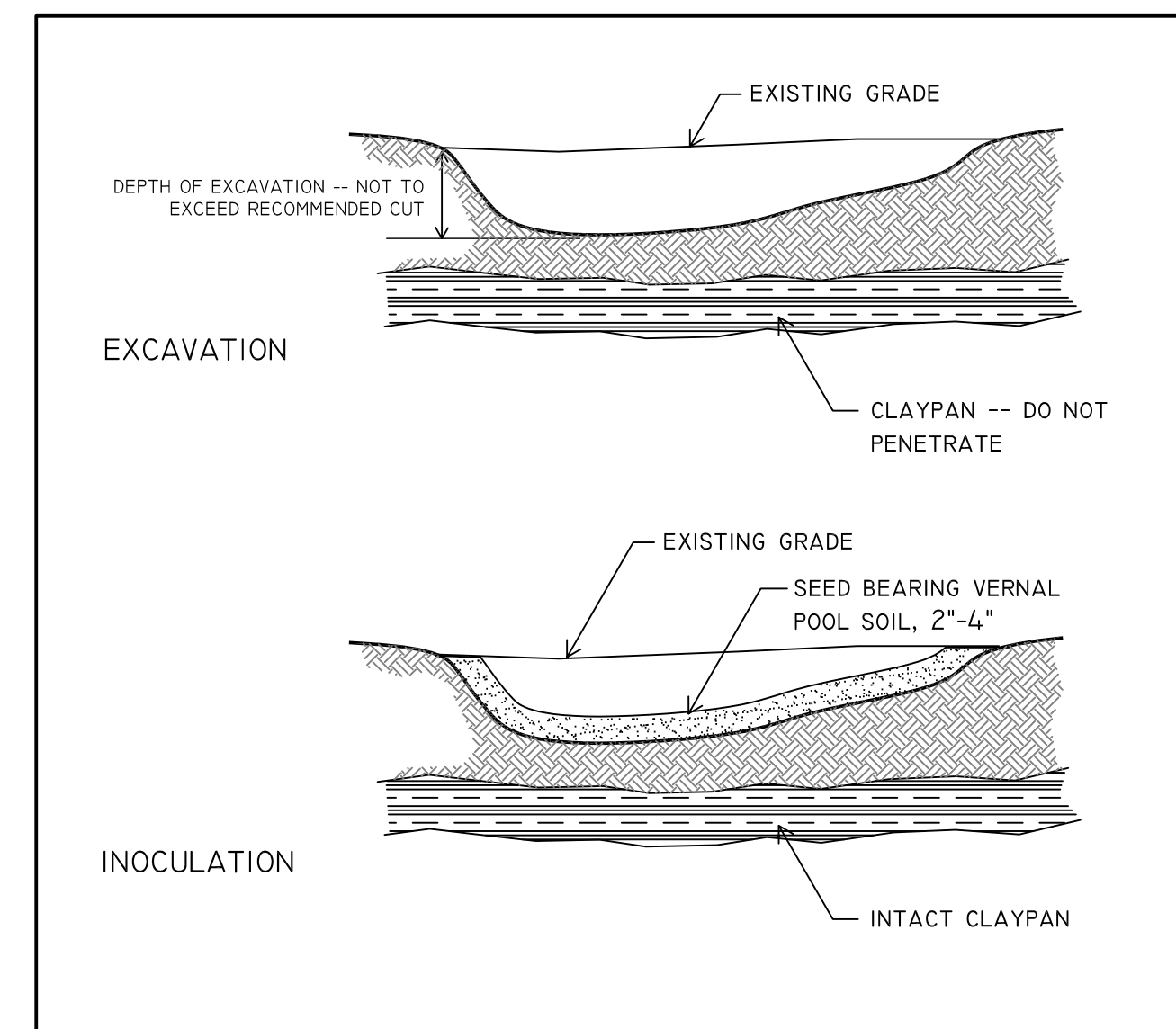

1 VERNAL POOL INOCULATION  
6 NOT TO SCALE

VERNAL POOL	SOIL TYPE	DEPTH TO CLAYPAN	CLAYPAN THICKNESS	DEPTH TO HARDPAN	RECOMMENDED CUT
VP-1	SAN JOAQUIN	15"	12"	27"	12"
VP-2	SAN JOAQUIN	19"	8"	27"	16"
VP-3	SAN JOAQUIN	19"	9"	28"	16"
VP-4	SAN JOAQUIN	21"	8"	29"	17"
VP-5	SAN JOAQUIN	24"	7"	31"	12"
VP-6	SAN JOAQUIN	19"	6"	25"	16"
VP-7	SAN JOAQUIN	6"	8"	14"	6"

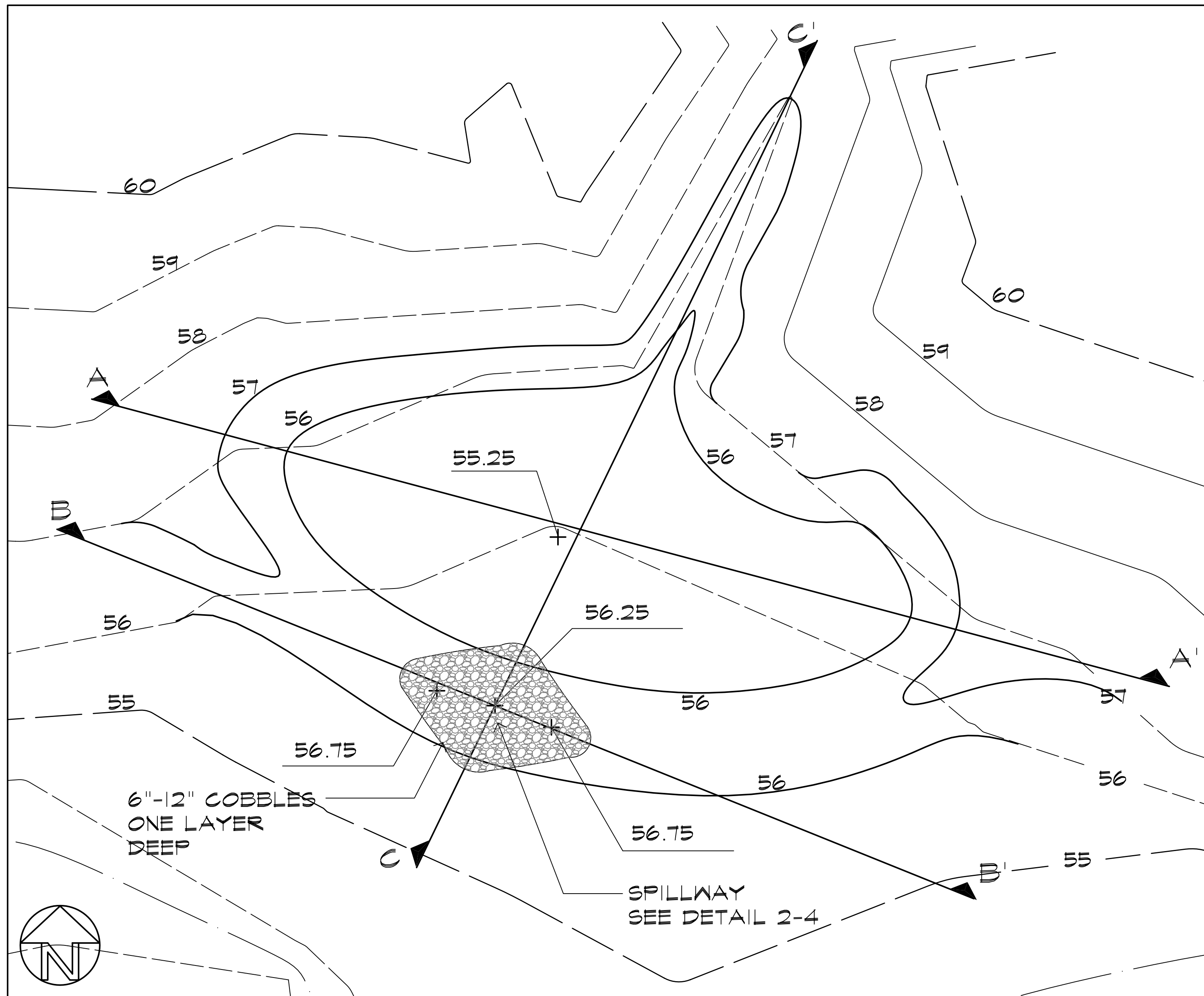

6"-12" COBBLES  
ONE LAYER  
DEEP

SPILLWAY  
SEE DETAIL 2-4

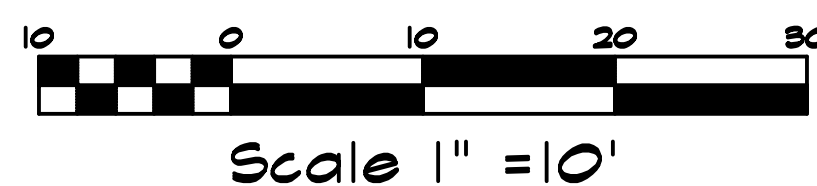

**NOTES:**

1. THE CONTRACTOR WILL HYDROSEED THE DETENTION WETLAND WITH THE FOLLOWING MIX: BASIC RIPARIAN MIX, AVAILABLE FROM S&S SEEDS, (805) 684-2798.

- ① DETENTION WETLAND
- ⑤ SCALE AS SHOWN

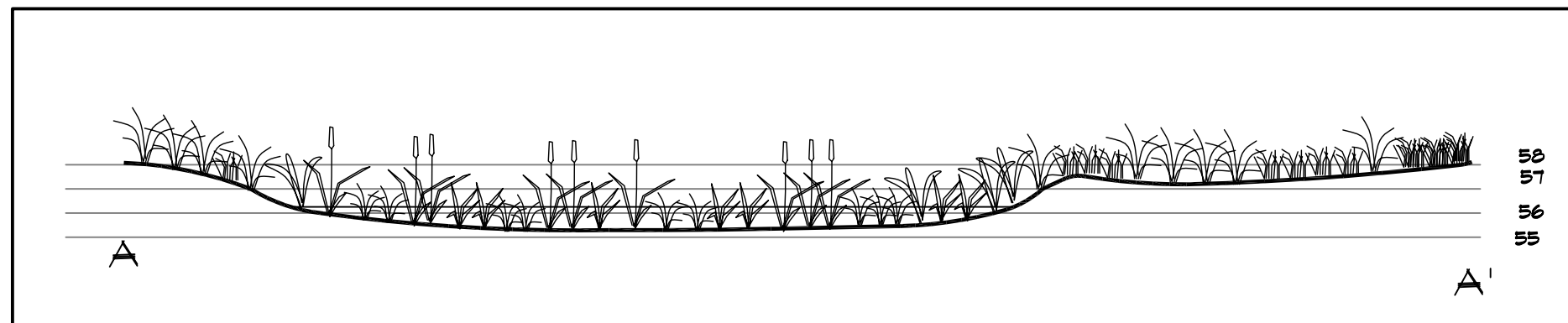

VERTICAL EXAGGERATION 3X 1" = 20'

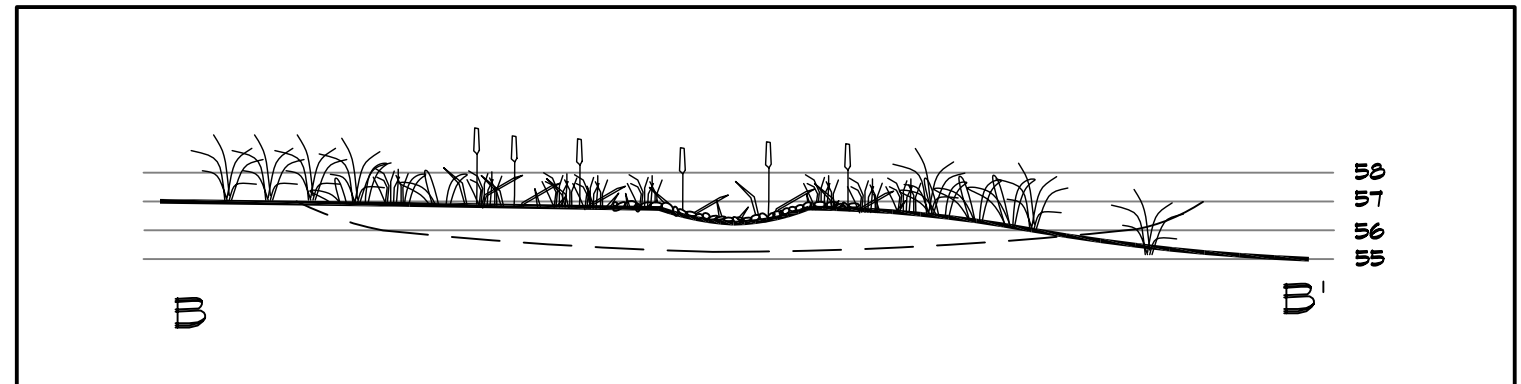

VERTICAL EXAGGERATION 3X 1" = 20'

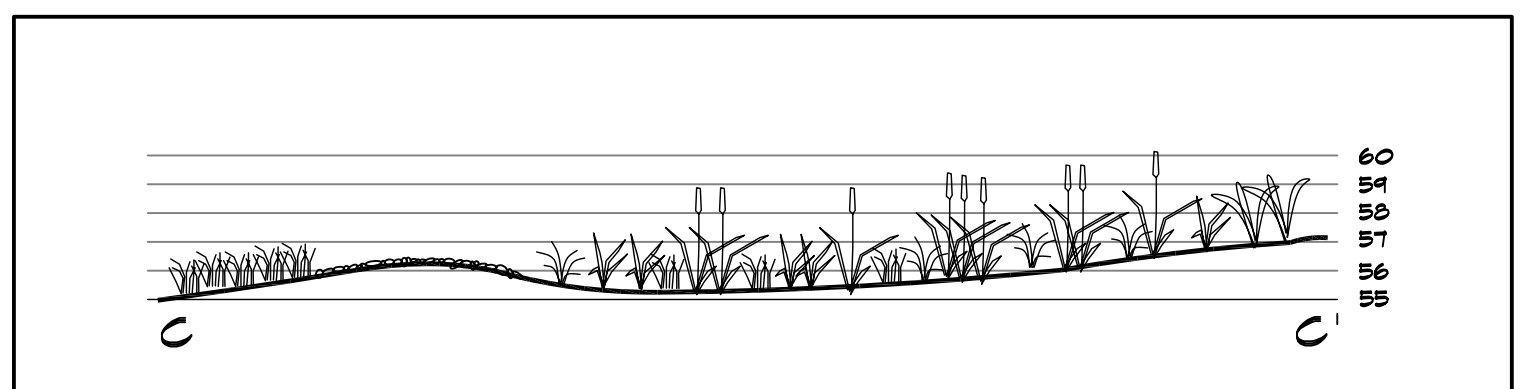

VERTICAL EXAGGERATION 3X 1" = 20'

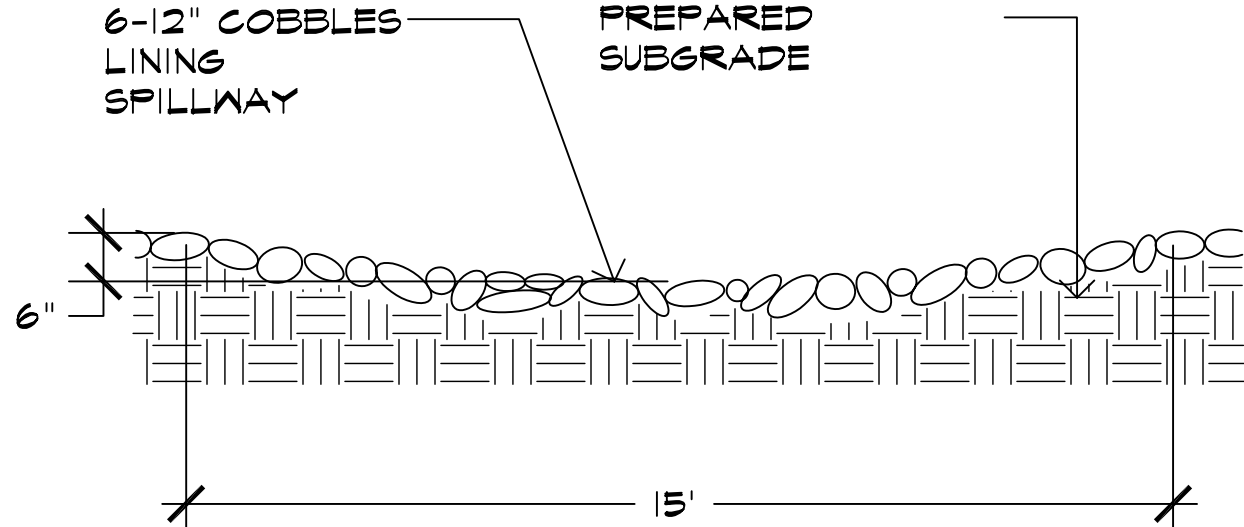

- ② SPILLWAY DETAIL
- ⑤ NOT TO SCALE