

RECORDS
6226

SACRAMENTO POLICE DEPARTMENT
CRIME REPORT

3 REPORT NUMBER
94-24279

CRIME BOTH 1
 CASUALTY
 ALL SUSPECTS ARRESTED 2
 SUSPECTS OUTSTANDING

4 CRIME CODE SECTION 211 SOURCE P.C. 5 CRIME DEFINITION Robbery - WEAPON 6 CRIME CLASS CODE RAWP
 7 CRIME CODE SECTION SOURCE 8 CRIME DEFINITION 9 CRIME CLASS CODE

10 CSI NOTIFIED YES NO
 11 DATE REPORTED 3-24-94 12 TIME REPORTED 0223 13 DATE OCCURRED 3-24-94 14 TIME OCCURRED 0220 15 DAY THU

16 LOCATION OF OCCURRENCE 5625 Folsom Blvd.

17 NAME/FIRM NAME IF CRIME AGAINST BUSINESS TACO BELL 18 AGE 19 DATE OF BIRTH 20 SEX 21 RACE
 22 RESIDENCE ADDRESS 23 RESIDENCE PHONE
 24 BUSINESS ADDRESS 5625 Folsom Blvd. 25 BUSINESS PHONE () 455-6493
 26 INJURED? IF VICTIM WAS INJURED, INDICATE CASUALTY DISPOSITION: CHECK () APPROPRIATE BOX
 YES NO A TAKEN TO SMC B TAKEN HOME C CORONER D REFUSED AID E OTHER: (SPECIFY)
 27 SPECIFY EXTENT OF INJURY TRANSPORTED BY

28 NAME SAME AS VICTIM 29 AGE 21 30 DATE OF BIRTH 31 SEX F 32 RACE W
 33 RESIDENCE ADDRESS 34 RESIDENCE PHONE
 35 BUSINESS ADDRESS 5625 Folsom Blvd. 36 BUSINESS PHONE

37 ROBBERY/ASSAULTS ONLY: MEANS OF ATTACK: (CHECK APPROPRIATE BOX)
 A FIREARM B KNIFE C PHYSICAL/NO WEAPON D OTHER WEAPON: (SPECIFY)
 38 VICTIM'S RELATIONSHIP TO SUSPECT: 39 BIAS - RELATED YES NO 40 DOMESTIC VIOLENCE YES NO COMPLIED WITH 13701 P.C. 41 GANG RELATED YES NO

42 CHECK WHERE APPLICABLE
 RESIDENCE: A HOUSE B APARTMENT C CONDOMINIUM D MOTEL/HOTEL ROOM E DUPLEX/FOURPLEX F MOBILE HOME G GARAGE ATTACHED H GARAGE DETACHED I YARD J DRIVEWAY K OTHER
 BUSINESS: A BANK/SAVINGS & LOAN B CREDIT UNION C OFFICE BUILDING D MEDICAL OFFICE E DRUG STORE F BAR G LIQUOR STORE H RESTAURANT/FAST FOODS I SUPERMARKET J CONVENIENCE STORE K DEPARTMENT STORE L CLOTHING STORE M JEWELRY STORE N SPORTING GOODS/GUNS O TV/RADIO/APPLIANCES P CAR, MOTORCYCLE, OR BICYCLE SALES Q PAWNSHOP/SECONDHAND R LAUNDROMAT/CLEANERS S THEATER/DRIVE-IN T GAS STATION/GARAGE U MOTEL/HOTEL V WAREHOUSE W MANUFACTURING FIRM X CONSTRUCTION SITE Y FENCED STORAGE Z BOX CAR 1 LONGHAUL TRAILER 2 PRIVATE SCHOOL 3 SPECIALTY SALES/REPAIR
 PUBLIC PREMISES: A STREET/HIGHWAY/ALLEY B SCHOOL C PARK/PLAYGROUND D PARKING LOT E PUBLIC BUILDING F CHURCH G HOSPITAL H DOWNTOWN MALL I BIKE TRAIL J SHOPPING CENTER K LIGHT RAIL L OTHER

CHECK () WHERE APPLICABLE
 43 POINT OF ENTRY WINDOW: A NONMOVABLE B SLIDING C CRANK TYPE D DOUBLE HUNG E LOUVERED OR WIND-WING DOOR: F SINGLE SWING G DOUBLE SWING H SLIDING I OVERHEAD GARAGE J OTHER OTHER: K FLOOR L ROOF M WALL N ALREADY ON PREMISES O UNKNOWN
 44 LOCATION OF ENTRY A FRONT B REAR C SIDE D OTHER E TOP 45 METHOD OF ENTRY A UNLOCKED/OPEN B Pried C BROKE GLASS D CHANNEL LOCKS E PASS KEY F BODY FORCE G CUT PADLOCK H REMOVED I EXPLOSIVE J VEHICLE FORCE K UNKNOWN L PUNCH LOCK M SLIPLOCK N OTHER
 46 ALARMS A NONE B RINGER C SILENT D SILENT/RINGER E NOT SET F BYPASSED G DISABLED 47 M.O. STYLE A CAT BURGLAR B DOOR KICK C DRUG HOUSE D DRIVE BY E DRUG USER K OTHER F PICK UP G FENCE H RUFE I SERIES J ATTEMPT 48 CAMERA YES NO

COMPLETE THE FOLLOWING BOXES IF CRIME AGAINST VICTIM'S VEHICLE OR INCIDENT OCCURRED IN A VEHICLE
 49 A AUTO B TRUCK C MOTORCYCLE D MOTOR HOME E VAN F OTHER G BICYCLE H VESSEL 50 YEAR 51 MAKE 52 MODEL 53 BODY STYLE
 54 COLOR(S) 55 LICENSE PLATE NUMBER STATE YEAR REG.

56 CONNECT-UP # TYPE 57 CONNECT-UP # TYPE 58 CONNECT-UP # TYPE

59 ACTIONS TAKEN WHEN INCIDENT REPORTED 1 SUSPECT ARRESTED 2 SUSPECT CITED 3 MEDICAL RELEASE 4 EVIDENCE BOOKED 5 FIELD EVIDENCE RELEASE 6 SUSPECT STATEMENT(S) 7 VICTIM STATEMENT(S) 8 PROPERTY DESCRIPTION(S) 9 SUSPECT STATEMENT(S) 10 OBSERVATIONS 2 WITNESS(ES) 3 SUSPECT(S) 4 SUSPECT VEHICLE 5 ADDITIONAL VICTIM(S) 6 PHYSICAL EVIDENCE 7 WITNESS STATEMENT(S)

61 REPORT PREPARED BY M. Labrode 62 BADGE 0566 63 DIV 01 64 YRS SERV 15 65 APPROVED BY [Signature] 66 BADGE [Number]
 67 ASSISTED BY S. Reese 68 BADGE 027501 69 DIV 01 70 YRS SERV 15 71 DATE 3-24-94 72 TIME 0700 PAGE 1 OF 15

- CRIME REPORT SUPPLEMENT
- MOTOR VEHICLE SUPPLEMENT
- INCIDENT SUPPLEMENT
- CASUALTY SUPPLEMENT

**SACRAMENTO POLICE DEPARTMENT
ADDITIONAL PERSONS/SUSPECT VEHICLE
SUPPLEMENT**

1 REPORT NUMBER
94-24279

2 VICTIM'S NAME
3 CRIME CODE SECTION

4A SUSPECT ONLY
B BOOKED:
CHARGES:
211 PC

6 NAME: **HOLMAN, Michael Gary**
7 AKA / NICKNAME: **BLOODSAW**

8 RESIDENCE ADDRESS: [REDACTED]
9 RESIDENCE PHONE: [REDACTED]

10 BUSINESS / SCHOOL ADDRESS: **Unemp**
11 BUSINESS PHONE: [REDACTED]

12 AGE: **31** 13 D.O.B.: **6-20-62** 14 SEX: **M** 15 RACE: **R** STATE: [REDACTED] 17 SOCIAL SECURITY NUMBER: [REDACTED]

18 HEIGHT: **6'2"** 19 WEIGHT: **240** 20 HAIR COLOR / STYLE / LENGTH: **Black Short** 21 EYE COLOR: **BRN** 22 BUILD: **Med**

23 COMPLEXION: LIGHT RUDDY FULL BEARD BALLCAP FULL BRIM MASK SKI
 DARK PALE LONG MUSTACHE WATCH UNUSUAL ODOR CLOTH RUBBER
 MEDIUM FRECKLED SHORT SIDEBURN UNIFORM HOLLOWEEN KNIT SURGICAL
 ACNE THIN UNSHAVEN LEATHER

24 FACIAL HAIR: [REDACTED] 25 HAT: [REDACTED] 26 MASK: [REDACTED] 27 GLASSES: [REDACTED] 28 GLOVES: [REDACTED] 29 SHOES: [REDACTED]

30 UPPER BODY CLOTHING / COLOR: **White T SHIRT** 31 LOWER BODY CLOTHING / COLOR: **TAN WORK PANTS**

32 GEN APP: CONSER DIRTY CLEAN FLASHY
33 Demeanor: HOSTILE IRRATIONAL NERVOUS APOLOGETIC PROFESSIONAL FRIENDLY
34 TRADE MARKS: SPEECH VOICE ACCENT LIPS MUMBLES OFFENSIVE QUIET
35 PROBABLE GANG NAME: [REDACTED]

36 WEAPON: [REDACTED] 37 PAROLE PROBATION SEARCHABLE ADULT JUV.
38 TYPE: SCARS MARKS TATTOOS PHY CHAR
39 SPECIFIC LOCATION: LEFT: [REDACTED] RIGHT: [REDACTED]

40 DESCRIPTION: [REDACTED] 41 COLOR: [REDACTED]

42 ADDITIONAL DESCRIPTION / CASUALTY INFORMATION:

4A SUSPECT ONLY
B BOOKED:
CHARGES:

6 NAME: [REDACTED] 7 AKA / NICKNAME: [REDACTED]

8 RESIDENCE ADDRESS: [REDACTED] 9 RESIDENCE PHONE: [REDACTED]

10 BUSINESS / SCHOOL ADDRESS: [REDACTED] 11 BUSINESS PHONE: [REDACTED]

12 AGE: [REDACTED] 13 D.O.B.: [REDACTED] 14 SEX: [REDACTED] 15 RACE: [REDACTED] 16 OLN: [REDACTED] STATE: [REDACTED] 17 SOCIAL SECURITY NUMBER: [REDACTED]

18 HEIGHT: [REDACTED] 19 WEIGHT: [REDACTED] 20 HAIR COLOR / STYLE / LENGTH: [REDACTED] 21 EYE COLOR: [REDACTED] 22 BUILD: [REDACTED]

23 COMPLEXION: [REDACTED] 24 FACIAL HAIR: [REDACTED] 25 HAT: [REDACTED] 26 MASK: [REDACTED] 27 GLASSES: [REDACTED] 28 GLOVES: [REDACTED] 29 SHOES: [REDACTED]

30 UPPER BODY CLOTHING / COLOR: [REDACTED] 31 LOWER BODY CLOTHING / COLOR: [REDACTED]

32 GEN APP: [REDACTED] 33 Demeanor: [REDACTED] 34 TRADE MARKS: [REDACTED] 35 PROBABLE GANG NAME: [REDACTED]

36 WEAPON: [REDACTED] 37 PAROLE PROBATION SEARCHABLE ADULT JUV.
38 TYPE: [REDACTED] 39 SPECIFIC LOCATION: [REDACTED]

40 DESCRIPTION: [REDACTED] 41 COLOR: [REDACTED]

42 ADDITIONAL DESCRIPTION / CASUALTY INFORMATION:

43 VEHICLE TYPE: AUTO TRUCK MOTORCYCLE MOTORHOME VAN BICYCLE

44 YEAR: **85** 45 MAKE: **CHEV** 46 MODEL: **CELEBRITY** 47 BODY STYLE: **4DR** 48 VEHICLE COLOR(S): **GRAN** 49 USED BY: **SUSP**

50 LICENSE PLATE NUMBER: [REDACTED] 51 YEAR: [REDACTED] 52 LIC. PLATE COLORS: [REDACTED] 53 REGISTERED OWNER ADDRESS: [REDACTED]

54 DAMAGE: FRONT END REAR END LEFT REAR RIGHT REAR LEFT FRONT RIGHT FRONT LEFT SIDE RIGHT SIDE

55 FEATURES: C/PAINT C/DESIGN DECAL MISS/PARTS

56 INTERIOR: BUCKET SEATS BENCH SEATS CUSTOMIZED SHIFT/STND

57 EXTERIOR: STEREO TAPE STICKER DECAL EQUIP ADD OR MISSING

58 MODIFIED: PINSTRIPED RUST/PRIMER CAMPER SHELL RACK

59 WHEELS: LOWERED RAISED HYDRAULICS

60 WINDOWS: MAGS STOCK OVERSIZED UNDERSIZE

61 LIGHTS OUT: BROKEN MISSING TINTED

62 CONDITION: LEFT FRONT LEFT REAR RIGHT FRONT RIGHT REAR

POOR FAIR GOOD EXCELLENT

* [REDACTED] **SUSPECT'S GRANDMOTHER CAR**

63 REPORTED BY: **M. Zukowski** 64 BADGE: **589** 65 DIV: **01** 66 ASSISTED BY: [REDACTED] 67 BADGE: [REDACTED] 68 DIV: [REDACTED] 69 APPROVED BY: [REDACTED] 70 BADGE: [REDACTED]

71 DATE: **3 Oct 94** 72 TIME: **0500**

SPD 104 (REV 8/90) PAGE **2** OF **15**

**SACRAMENTO POLICE DEPARTMENT
ADDITIONAL PERSONS/SUSPECT VEHICLE
SUPPLEMENT**

REPORT NUMBER
94-24279

- CRIME REPORT SUPPLEMENT
- MOTOR VEHICLE SUPPLEMENT
- INCIDENT SUPPLEMENT
- CASUALTY SUPPLEMENT

2 VICTIMS NAME **TACO BELL** 3 CRIME CODE SECTION

4A SUSPECT ONLY
B BOOKED:
CHARGES:
7 AKA / NICKNAME
8 RESIDENCE
11 BUSINESS PHONE

12 AGE **64** 14 SEX **F** 15 RACE **B** 16 OLN STATE 17 SOCIAL SECURITY NUMBER

C CITED: 18 HEIGHT 19 WEIGHT 20 HAIR COLOR / STYLE / LENGTH 21 EYE COLOR 22 BUILD

CITATION # 23 COMPLEX LIGHT DARK MEDIUM ACNE RUDDY PALE FRECKLED 24 FACIAL HAIR FULL LONG SHORT THIN BEARD MUSTACHE SIDEBURN UNSHAVEN HAT BALLCAP WATCH UNIFORM FULL BRIM SMALL BRIM MASK CLOTH HALLOWEEN SKI CLEAR TINTED SUN 27 GLASSES CLEAR TINTED SUN 28 GLOVES CLOTH RUBBER SKI RUBBER SURGICAL LEATHER 29 SHOES COWBOY BOOTS WORK BOOTS TENNIS / SPORT DRESS HEEL SANDAL

D WITNESS
E ADD'L VICTIM
 NOT INJURED
 INJURED

30 UPPER BODY CLOTHING / COLOR 31 LOWER BODY CLOTHING / COLOR
32 GEN APP CONSER DIRTY CLEAN FLASHY 33 Demeanor HOSTILE IRRATIONAL NERVOUS APOLOGETIC PROFESSIONAL FRIENDLY 34 TRADE MARKS ACCENT LISPS MUMBLES OFFENSIVE SLEET VOICE DIST LOUD NASAL RASP SOFT 35 PROBABLE GANG NAME
36 WEAPON TYPE COLOR CALIBER

5 CASUALTY DISPOSITION
A TAKEN TO HOSPITAL
B TAKEN HOME
C CORONER
D OTHER:
37 PAROLE PROBATION SEARCHABLE ADULT JUV. 38 TYPE SCARS MARKS TATTOOS PHY CHAR 39 SPECIFIC LOCATION: LEFT: RIGHT:
40 DESCRIPTION: 41 COLOR

42 ADDITIONAL DESCRIPTION / CASUALTY INFORMATION: **SUSPECT'S GRANDMOTHER, ALSO REGISTERED OWNER OF SUSPECT VEHICLE.**

TRANSPORTING UNIT:

4A SUSPECT ONLY
B BOOKED:
CHARGES:
7 AKA / NICKNAME

9 RESIDENCE
11 BUSINESS PHONE
12 AGE **50** 14 SEX **F** 15 RACE **B** 16 OLN STATE 17 SOCIAL SECURITY NUMBER

18 HEIGHT 19 WEIGHT 20 HAIR COLOR / STYLE / LENGTH 21 EYE COLOR 22 BUILD

C CITED: 23 COMPLEX LIGHT DARK MEDIUM ACNE RUDDY PALE FRECKLED 24 FACIAL HAIR FULL LONG SHORT THIN BEARD MUSTACHE SIDEBURN UNSHAVEN HAT BALLCAP WATCH UNIFORM FULL BRIM SMALL BRIM MASK CLOTH HALLOWEEN SKI CLEAR TINTED SUN 27 GLASSES CLEAR TINTED SUN 28 GLOVES CLOTH RUBBER SKI RUBBER SURGICAL LEATHER 29 SHOES COWBOY BOOTS WORK BOOTS TENNIS / SPORT DRESS HEEL SANDAL

D WITNESS
E ADD'L VICTIM
 NOT INJURED
 INJURED

30 UPPER BODY CLOTHING / COLOR 31 LOWER BODY CLOTHING / COLOR
32 GEN APP CONSER DIRTY CLEAN FLASHY 33 Demeanor HOSTILE IRRATIONAL NERVOUS APOLOGETIC PROFESSIONAL FRIENDLY 34 TRADE MARKS ACCENT LISPS MUMBLES OFFENSIVE SLEET VOICE DIST LOUD NASAL RASP SOFT 35 PROBABLE GANG NAME
36 WEAPON TYPE COLOR CALIBER

5 CASUALTY DISPOSITION
A TAKEN TO HOSPITAL
B TAKEN HOME
C CORONER
D OTHER:
37 PAROLE PROBATION SEARCHABLE ADULT JUV. 38 TYPE SCARS MARKS TATTOOS PHY CHAR 39 SPECIFIC LOCATION: LEFT: RIGHT:
40 DESCRIPTION: 41 COLOR

42 ADDITIONAL DESCRIPTION / CASUALTY INFORMATION: **SUSPECTS COUSIN... HAD KEYS TO SUSPECT VEH, WHEN SHE FELL ASLEEP. AWAKE TO FIND KEYS, SUSPECT AND VEH. GONE.**

TRANSPORTING UNIT:

43 VEHICLE TYPE AUTO TRUCK MOTORCYCLE MOTORHOME VAN BICYCLE 44 YEAR 45 MAKE 46 MODEL 47 BODY STYLE 48 VEHICLE COLOR(S) 49 USED BY:
50 LICENSE PLATE NUMBER STATE 51 YEAR 52 LIC. PLATE COLORS 53 REGISTERED OWNER / ADDRESS:

54 DAMAGE TOP FRONT END LEFT REAR LEFT FRONT LEFT SIDE REAR END RIGHT REAR RIGHT FRONT RIGHT SIDE 55 FEATURES C/PAINT C/DESIGN DECAL MISS/PARTS 56 INTERIOR BUCKET SEATS BENCH SEATS CUSTOMIZED SHIFT/STND STEREO TAPE STICKER DECAL EQUIP ADD OR MISSING 57 EXTERIOR PINSTRIPED RUST/PRIMER CAMPER SHELL RACK 58 MODIFIED LOWERED RAISED HYDRAULICS 59 WHEELS MAGS STOCK OVERSIZED UNDERSIZE 60 WINDOWS BROKEN MISSING TINTED 61 LIGHTS OUT LEFT FRONT LEFT REAR RIGHT FRONT RIGHT REAR 62 CONDITION POOR FAIR GOOD EXCELLENT

63 REPORTED BY **J PANETT** 64 BADGE **447603** 65 DIV **603** 66 ASSISTED BY 67 BADGE 68 DIV 69 APPROVED BY 70 BADGE

71 DATE 72 TIME

**SACRAMENTO POLICE DEPARTMENT
OFFICER'S BOOKING AND FIELD RECEIPT**

LOCKERS USED _____ CHARGE(S) 211 PC REPORT # 94-24279
 NARCO/MONEY BOOKING CITATION # _____
 LARGE PROPERTY BOOKING SEARCH WARRANT # _____
 PREVIOUS BOOKING PR # _____

LOCATION OF OCCURRENCE 5625 Folsom Blvd

VICTIM(S) FULL NAME						FIELD RECEIPT		
LAST	FIRST	MIDDLE	DOB	ADDRESS	ZIP	EVIDENCE	SEARCHING	SAFETY
<u>TACO BELL</u>				<u>5625 Folsom</u>		<input checked="" type="checkbox"/>	<input checked="" type="checkbox"/>	<input checked="" type="checkbox"/>
						DOMESTIC VIOLENCE	<input type="checkbox"/>	<input type="checkbox"/>
						5150 HOLD	<input type="checkbox"/>	<input type="checkbox"/>
						FOUND PROPERTY	<input type="checkbox"/>	<input type="checkbox"/>
						PERSONAL PROPERTY	<input type="checkbox"/>	<input type="checkbox"/>

DEFENDANT(S) FULL NAME						BOOKED	SUSPECT	CITED
LAST	FIRST	MIDDLE	DOB	ADDRESS	ZIP			
<u>HOLMAN</u>	<u>MICHAEL</u>	<u>GARY</u>	<u>6-20-62</u>	[REDACTED]		<input checked="" type="checkbox"/>		

REPORTING OFFICER M. ZAKOWSKI BADGE # 589 DIV 01 RECEIVED DATE 3-24-94 TIME 0345 IN LOCKER DATE 3-21-94 TIME 0435

ITEM #	DESCRIBE PROPERTY BELOW IN THE FOLLOWING SEQUENCE: ITEM TYPE NO-PIECES - COLOR - BRAND - MOD - SER - QAN - DESCRIPTION - CALIBER - MONEY AMOUNT - BLADE/BARREL/OVERALL LENGTH	IN FIREARM CASES, IF READILY AVAILABLE IDENTIFY ALL OWNERS & ADULT COHABITANTS. RECORD FULL NAMES, DOB, SS #, CADL #, ADDRESS OF PERSON FROM WHOM RECEIVED. INDICATE IF COHABITANT, OWNER, ETC.				CRIME LAB	PRINT
		NAME	ADDRESS	DOB	SS # OLN	YES <input type="checkbox"/> NO <input type="checkbox"/>	YES <input type="checkbox"/> NO <input type="checkbox"/>
<u>1</u>	<u>ROCK COCAINE APPROX 0.5g - VALTOX POS</u>	<input type="checkbox"/> OWNER <input checked="" type="checkbox"/> TKN FROM <input type="checkbox"/> CO-HAB	<u>DEF</u>			<input checked="" type="checkbox"/>	<input checked="" type="checkbox"/>
<u>2</u>	<u>MONEY US CURRENCY TOTAL OF SIXTY SEVEN DOLLARS SIXTEEN CENTS \$67.16</u>	<input type="checkbox"/> OWNER <input checked="" type="checkbox"/> TKN FROM <input type="checkbox"/> CO-HAB	<u>DEF</u>			<input checked="" type="checkbox"/>	<input checked="" type="checkbox"/>
<u> </u>		<input type="checkbox"/> OWNER <input type="checkbox"/> TKN FROM <input type="checkbox"/> CO-HAB				<input type="checkbox"/>	<input type="checkbox"/>
<u> </u>		<input type="checkbox"/> OWNER <input type="checkbox"/> TKN FROM <input type="checkbox"/> CO-HAB				<input type="checkbox"/>	<input type="checkbox"/>
<u> </u>		<input type="checkbox"/> OWNER <input type="checkbox"/> TKN FROM <input type="checkbox"/> CO-HAB				<input type="checkbox"/>	<input type="checkbox"/>
<u> </u>		<input type="checkbox"/> OWNER <input type="checkbox"/> TKN FROM <input type="checkbox"/> CO-HAB				<input type="checkbox"/>	<input type="checkbox"/>
<u> </u>		<input type="checkbox"/> OWNER <input type="checkbox"/> TKN FROM <input type="checkbox"/> CO-HAB				<input type="checkbox"/>	<input type="checkbox"/>
<u> </u>		<input type="checkbox"/> OWNER <input type="checkbox"/> TKN FROM <input type="checkbox"/> CO-HAB				<input type="checkbox"/>	<input type="checkbox"/>

OFFICER M. ZAKOWSKI #589 SIGNATURE AND BADGE NUMBER CITIZEN _____ DATE _____
 IF FIELD RECEIPT, HAVE CITIZEN SIGN

1 WHITE - PROPERTY 2 WHITE - REPORT 3 PINK - INVESTIGATIONS 4 GOLDENROD - FIELD RECEIPT

- CRIME REPORT SUPPLEMENT
- MOTOR VEHICLE SUPPLEMENT
- COLLISION/TRAFFIC SUPPLEMENT
- INCIDENT REPORT SUPPLEMENT
- CASUALTY REPORT SUPPLEMENT
- MEMORANDUM

SACRAMENTO POLICE DEPARTMENT
REPORT SUPPLEMENT

1 REPORT NUMBER
94-24279

VICTIM OR COMPLAINANT	
2 LAST NAME, FIRST, MIDDLE (FIRM NAME IF CRIME AGAINST BUSINESS)	3 CRIME CODE SECTION 211 PC

NARRATIVE

1	PROPERTY DESCRIPTION :
2	Approx - \$102 ⁰⁰ IN US CASH.
3	
4	WITNESS STATEMENT : R/O - CONTACTED
5	WITNESS [REDACTED] AT THE
6	SCENE. SHE STATED THAT SHE IS
7	ONE OF THE NIGHT EMPLOYEES AND
8	WAS WORKING THIS EVENING. SHE
9	SAID THAT THE SUSPECT DROVE UP
10	TO THE DRIVE UP MENU & ORDERED
11	A BURRITO. SHE SAID THAT THE
12	SUSPECT DROVE UP TO THE PICK UP
13	WINDOW AND GAVE HER ONE DOLLAR
14	FOR THE BURRITO HE HAD ORDERED.
15	
16	THE WIT- SAID SHE GAVE HIM
17	BACK CHANGE FROM HIS DOLLAR &
18	he held up a small black REVOLVER
19	in his RT hand. SHE SAID THE
20	SUSPECT TOLD HER TO GIVE HIM ALL
21	THE MONEY AND NOT TO MESS
22	AROUND. [REDACTED] STATED SHE GAVE
23	THE SUSPECT ALL THE CASH FROM
24	THE TILL & he DROVE OFF IN THE
25	SUSPECT VEHICLE. [REDACTED] SAID SHE

4 REPORTED BY S Reese	5 BADGE 275	6 DIV 01	7 YRS OF SERVICE 15	8 DATE 3/22/94	9 APPROVED BY [Signature]	
10 ASSISTED BY	11 BADGE	12 DIV	13 YRS OF SERVICE	14 TIME	15 DATE	17 TIME

- CRIME REPORT SUPPLEMENT
- MOTOR VEHICLE SUPPLEMENT
- COLLISION/TRAFFIC SUPPLEMENT
- INCIDENT REPORT SUPPLEMENT
- CASUALTY REPORT SUPPLEMENT
- MEMORANDUM

SACRAMENTO POLICE DEPARTMENT
REPORT SUPPLEMENT

1 REPORT NUMBER
94-24279

VICTIM OR COMPLAINANT

2 LAST NAME, FIRST, MIDDLE (FIRM NAME IF CRIME AGAINST BUSINESS)	3 CRIME CODE SECTION 211 PC
--	---------------------------------------

NARRATIVE

1	<u>WIT- STATEMENT CONT.</u>
2	THEN CALLED THE POLICE. SHE TOLD
3	R/O - THAT THE GUN LOOKED LIKE
4	IT HAD SOME "RED" COLORING
5	ON IT. THE WIT- SAID THE
6	CULPRIT GOT APPROX- \$102 ⁰⁰ IN
7	CASH. SHE STATED THAT SHE
8	COULD POSITIVELY ID THE SUSPECT.
9	
10	OBSERVATIONS: ON 3-24-94, AT
11	APPROX - 0225 HRS., R/O -
12	S. REESE # 0275, RESPONDED TO
13	THE TACO BELL AT 5625 FOLSOM
14	RE: A ROBBERY WHICH HAD JUST
15	OCCURRED. UPON ARRIVAL, APPROX-
16	0227 HRS., R/O- CONTACTED THE
17	WIT/RP- AND OBTAINED HER STATEMENT
18	A DESCRIPTION WAS PUT OUT ON THE
19	CAR WHICH WAS LOCATED A SHORT
20	TIME LATER BY OFFICERS. (SEE
21	SUPPLEMENTS). CSI NOT REQUESTED
22	DUE TO SUSP- NOT TOUCHING ANYTHING
23	AT THE SCENE.
24	
25	

4 REPORTED BY S. REESE	5 BADGE 027501	6 DIV 15	7 YRS OF SERVICE	8 DATE	9 APPROVED BY <i>[Signature]</i>
10 ASSISTED BY	11 BADGE	12 DIV	13 YRS OF SERVICE	14 TIME	15 BARGE <i>[Signature]</i>
					16 DATE
					17 TIME

- CRIME REPORT SUPPLEMENT
- MOTOR VEHICLE SUPPLEMENT
- COLLISION/TRAFFIC SUPPLEMENT
- INCIDENT REPORT SUPPLEMENT
- CASUALTY REPORT SUPPLEMENT
- MEMORANDUM

SACRAMENTO POLICE DEPARTMENT
REPORT SUPPLEMENT

1 REPORT NUMBER
94-24279

VICTIM OR COMPLAINANT

2 LAST NAME, FIRST, MIDDLE (FIRM NAME IF CRIME AGAINST BUSINESS)	3 CRIME CODE SECTION 211 PC
--	--------------------------------

NARRATIVE

1	
2	<u>SUPPLEMENTS 589:</u>
3	
4	R/O ZUKOWSKI (ALPHA-32) ARRIVED ON SCENE AS
5	THE SUSPECT WAS BEING TAKEN INTO CUSTODY. SUSPECT
6	HOLMAN WAS PLACED IN THE REAR SEAT OF R/O'S
7	VEHICLE; EQUIP # 6858.
8	
9	TWO BELL PERSONNEL WERE TRANSPORTED TO THE SCENE
10	FOR ELIMINATION. HOLMAN WAS POSITIVELY IDENTIFIED AS
11	THE RESPONSIBLE IN THE ROBBERY.
12	
13	HOLMAN REFUSED TO MAKE A FORMAL STATEMENT UNDER
14	MIRANDA. HOWEVER HOLMAN MADE SEVERAL SPONTANEOUS
15	STATEMENTS WHILE IN CUSTODY. AT THE SCENE OF THE
16	ARREST HOLMAN BEGGED OFFICERS TO SHOOT HIM SO HE
17	WOULDN'T HAVE TO FACE PRISON [REDACTED]. HOLMAN
18	SPoke OF HIS ONE HUNDRED FIFTY / TWO HUNDRED DOLLAR
19	A DAY COCAINE HABIT AND THAT HE WAS ON A TWO
20	WEEK RADDON.
21	
22	AT COUNTY JAIL, R/O LOCATED FORTY SEVEN DOLLARS
23	(\$47.00) IN HOLMAN'S RIGHT FRONT PANTS POCKET.
24	TWENTY DOLLARS AND SIXTEEN CENTS (\$20.16) WAS
25	(CONT)

4 REPORTED BY ZUKOWSKI	5 BADGE 589	6 DIV 01	7 YRS OF SERVICE 12	8 DATE 3/24/94	9 APPROVED BY		
10 ASSISTED BY	11 BADGE	12 DIV	13 YRS OF SERVICE	14 TIME 0510	15 BADGE	16 DATE	17 TIME

- CRIME REPORT SUPPLEMENT
- MOTOR VEHICLE SUPPLEMENT
- COLLISION/TRAFFIC SUPPLEMENT
- INCIDENT REPORT SUPPLEMENT
- CASUALTY REPORT SUPPLEMENT
- MEMORANDUM

**SACRAMENTO POLICE DEPARTMENT
REPORT SUPPLEMENT**

1 REPORT NUMBER
94-24279

VICTIM OR COMPLAINANT

2 LAST NAME, FIRST, MIDDLE (FIRM NAME IF CRIME AGAINST BUSINESS)	3 CRIME CODE SECTION 211 PC
--	---------------------------------------

NARRATIVE

1	
2	<u>SUPPLEMENTS CONT 589:</u>
3	
4	LOCATED IN HOLMAN'S LEFT FRONT PANTS POCKET.
5	
6	A SMALL AMOUNT OF ROOK COCAINE WAS LOCATED IN
7	HOLMAN'S LEFT WORK BOOT (0.5g VALTOX POSITIVE).
8	HOLMAN MADE THE SPONTANEOUS STATEMENT THAT HE
9	SPENT THIRTY DOLLARS (\$30.00) FROM THE ROBBERY
10	TO PURCHASE THE COCAINE. HOLMAN SAID HE SMOKE
11	A PORTION OF THE COCAINE PRIOR TO HIS ARREST
12	AND THAT THE "PIPE" COULD BE FOUND ON THE FLOOR
13	BOARD OF THE SUSPECT VEHICLE.
14	
15	MONEY AND COCAINE WERE LOCATED DURING PRE-
16	BOOKING INTERVIEW. Sgt Mike Roy WAS WITNESS TO
17	THE SPONTANEOUS STATEMENTS AT THE SCENE AS WELL
18	AS COUNTY JAIL.
19	
20	EVIDENCE BOOKED AT 625 H STREET, 3-24-94 0435hrs
21	
22	
23	
24	
25	

4 REPORTED BY Cukowski	5 BADGE 589	6 DIV 01	7 YRS OF SERVICE 12	8 DATE 3/24/94	9 APPROVED BY		
10 ASSISTED BY	11 BADGE	12 DIV	13 YRS OF SERVICE	14 TIME 0521	15 BADGE	16 DATE	17 TIME

- CRIME REPORT SUPPLEMENT
- MOTOR VEHICLE SUPPLEMENT
- COLLISION/TRAFFIC SUPPLEMENT
- INCIDENT REPORT SUPPLEMENT
- CASUALTY REPORT SUPPLEMENT
- MEMORANDUM

SACRAMENTO POLICE DEPARTMENT
REPORT SUPPLEMENT

1 REPORT NUMBER
94-24279

VICTIM OR COMPLAINANT

2 LAST NAME, FIRST MIDDLE (FIRM NAME IF CRIME AGAINST BUSINESS) TACO BELL
3 CRIME CODE SECTION 211

NARRATIVE

1 OBSERVATIONS →
 2 0225 HRS, 3-24-94, I RESPONDED
 3 TO THE TACO BELL RESTAURANT AT 5625 FOLSOM
 4 BLVD. ON AN ARMED ROBBERY JUST OCCURRED.
 5 SUSPECT DESCRIPTION WHICH WAS
 6 BROADCASTED AT THE TIME OF DISPATCH →
 7 MALE BLACK, DRIVING A GREY CHEV, BEARING
 8 LIC. PLATE # [REDACTED]
 9 ARRIVAL AT TACO BELL WAS AT
 10 APPROX 0226 HRS., UPON ARRIVAL I ASSISTED
 11 OFFICER STEVE REESE IN CONTACTING VICTIM
 12 AND CHECKING FOR ANY OTHER WITNESSES.
 13 REGISTRATION CHECK ON THE
 14 LICENSE PLATE [REDACTED] RETURNED TO A
 15 [REDACTED] OF [REDACTED]
 16 [REDACTED]
 17 BASED ON THE SUSPECT VEH'S
 18 REG. OWNER INFO, I RESPONDED TO [REDACTED]
 19 [REDACTED] 0239 HRS, UNIT 1-ALCS
 20 (DUBRAY) AND I ARRIVED AT THE ADDRESS.
 21 OFFICER DUBRAY AND I CHECKED THE APT.
 22 COMPLEX - PARKING LOT FOR THE SUSPECT VEH.
 23 WITH NEG. RESULTS,
 24 DUBRAY AND I THEN KNOCKED
 25 AT [REDACTED] MOMENTS LATER WITNESS →

4 REPORTED BY J. FINE 5 BADGE 456 6 DIV 03 7 YRS OF SERVICE 15 8 DATE 3-24-94 9 APPROVED BY
 10 ASSISTED BY 11 BADGE 12 DIV 13 YRS OF SERVICE 14 TIME 0415 15 BADGE 16 DATE 17 TIME 9 15

- CRIME REPORT SUPPLEMENT
- MOTOR VEHICLE SUPPLEMENT
- COLLISION/TRAFFIC SUPPLEMENT
- INCIDENT REPORT SUPPLEMENT
- CASUALTY REPORT SUPPLEMENT
- MEMORANDUM

SACRAMENTO POLICE DEPARTMENT
REPORT SUPPLEMENT

1 REPORT NUMBER
94-24279

VICTIM OR COMPLAINANT

2 LAST NAME, FIRST, MIDDLE (FIRM NAME IF CRIME AGAINST BUSINESS) TACO BELL	3 CRIME CODE SECTION 211
--	------------------------------------

NARRATIVE

1	OBSERVATIONS CONTD # 1
2	[REDACTED]
3	[REDACTED] (SUSPECT'S COUSIN) ANSWERED THE
4	DOOR, I ASKED [REDACTED] IF [REDACTED]
5	WAS HOME [REDACTED] STATED SHE WAS AND THEN
6	CALLED OUT, WAKING [REDACTED]
7	I ASKED [REDACTED] IF SHE STILL
8	OWNED THE CHEV. [REDACTED] AND IF SHE
9	KNEW WHO WAS DRIVING THE VEH. TONIGHT
10	[REDACTED] APPEARED SURPRISED AND STATED
11	HER CAR SHOULD STILL BE IN THE PARKING
12	LOT. [REDACTED] THEN STATED THAT A SET OF
13	KEYS TO THE CAR WERE MISSING AND THAT
14	MOST LIKELY HER COUSIN - MICHAEL HOLMAN
15	HAD TAKEN THE KEYS + CAR AFTER EVERYONE
16	WENT TO SLEEP,
17	AT THIS TIME, I COPIED A
18	RADIO BROADCAST OF SPD OFFICERS IN A
19	VEH. PURSUIT OF THE 211 VEH. [REDACTED]
20	THE PURSUIT WAS IN THE AREA OF STOCKTON
21	BLDG. & 8TH AVE. I IMMEDIATELY RESPONDED
22	TO THE AREA, WHILE ENROUTE OFFICERS
23	ADVISED OF SHOTS FIRED, FOOT PURSUIT &
24	THE SUSPECT IN CUSTODY, [REDACTED] BACK
25	I THEN RESPONDED TO THE

4 REPORTED BY J. PATE	5 BADGE 456	6 DIV 03	7 YRS OF SERVICE 15	8 DATE 5-19-94	9 APPROVED BY 		
10 ASSISTED BY	11 BADGE	12 DIV	13 YRS OF SERVICE	14 TIME 0510	15 BADGE	16 DATE	17 TIME

- CRIME REPORT SUPPLEMENT
- MOTOR VEHICLE SUPPLEMENT
- COLLISION/TRAFFIC SUPPLEMENT
- INCIDENT REPORT SUPPLEMENT
- CASUALTY REPORT SUPPLEMENT
- MEMORANDUM

SACRAMENTO POLICE DEPARTMENT
REPORT SUPPLEMENT

1 REPORT NUMBER
94-24279

VICTIM OR COMPLAINANT

2 LAST NAME, FIRST, MIDDLE (FIRM NAME IF CRIME AGAINST BUSINESS) TACO BELL
3 CRIME CODE SECTION 211

NARRATIVE

1 OBSERVATIONS CONTD #2

2

3 -> TACO BELL. I RECONTACTED VICTIM

4 [REDACTED]. I ASKED [REDACTED] IF SHE

5 FELT SHE COULD IDENTIFY THE SUSPECT IF

6 SHE SAW HIM AGAIN. [REDACTED] STATED

7 SHE FELT CONFIDENT SHE COULD. I THEN

8 TOLD [REDACTED] THAT OFFICERS HAVE A MAN

9 STOPPED AND I REQUESTED SHE ACCOMPANY

10 ME TO THE STOP FOR POSSIBLE I.D.,

11 [REDACTED] AGREED, STATING SHE HAD TO CLOSE

12 THE TACO BELL PRIOR TO LEAVING.

13 0306 HRS, I TRANSPORTED VICT.

14 [REDACTED] TO SAN JOSE WAY JUST NORTH OF

15 8TH AVE. I FACED MY VEH. N/B SAN JOSE

16 WAY FROM 8TH AVE, APPROX. FIFTEEN ^{TO THE} NORTH

17 OFFICER S. REESE GUIDED THE HANDCUFFED

18 SUSPECT MICHAEL HOLMAN OUT OF A SQUAD UNIT.

19 HOLMAN FACED MY SQUAD UNIT AND WAS

20 ILLUMINATED BY VEH. HIGH BEAMS. VICT. [REDACTED]

21 LOOKED AT HOLMAN FOR 15 TO 30 SECONDS THEN

22 SAID: "YEP I THINK THATS HIM. CAN WE GET

23 A LITTLE CLOSER". I THEN PROVE TOWARD

24 SUSPECT HOLMAN UNTIL WE WERE APPROX.

25 FIVE FEET AWAY. [REDACTED] THEN STATED

4 REPORTED BY J. PANETTI	5 BADGE 152	6 DIV 03	7 YRS OF SERVICE 15	8 DATE 8-24-94	9 APPROVED BY		
10 ASSISTED BY	11 BADGE	12 DIV	13 YRS OF SERVICE	14 TIME 0505	15 BADGE	16 DATE	17 TIME

- CRIME REPORT SUPPLEMENT
- MOTOR VEHICLE SUPPLEMENT
- COLLISION/TRAFFIC SUPPLEMENT
- INCIDENT REPORT SUPPLEMENT
- CASUALTY REPORT SUPPLEMENT
- MEMORANDUM

**SACRAMENTO POLICE DEPARTMENT
REPORT SUPPLEMENT**

1 REPORT NUMBER
94-24279

VICTIM OR COMPLAINANT

2 LAST NAME, FIRST, MIDDLE (FIRM NAME IF CRIME AGAINST BUSINESS) **TACO BELL** 3 CRIME CODE SECTION **211**

NARRATIVE

1 OBSERVATIONS CONT'D #3

2
3 : "YEP IM SURE THATS HIM". HOWMAN WAS
4 TAKEN PLACED BACK IN THE SQUAD CAR
5 (POSITIVE I.D. 0315 HRS.)

6 I THEN PROCEEDED A LITTLE
7 FURTHER N/B ON SAN JOSE WAY AT WHICH
8 TIME [REDACTED] NOTICED THE SUSPECT VEH.
9 AND STATED "HEY THERES THE CAR... WAS
10 I RIGHT ABOUT THE LICENSE PLATE"

11 OFFICER REESE THEN LED
12 [REDACTED] TO THE OPENED DRIVER'S SIDE
13 DOOR OF THE SUSPECT VEH.. REESE POINTED
14 INSIDE THE VEH. ON THE FRONT SEAT TO
15 WHERE THE SUSPECT'S GUN WAS RESTING.

16 [REDACTED] SAW THE GUN AND SAID: "THATS
17 THE GUN... IS IT A PHONY"

18 I TRANSPORTED VICTIM
19 [REDACTED] BACK TO TACO BELL AND WAITED
20 UNTIL SHE GOT BACK INSIDE.

21 *OUT OF SEQUENCE*

22 WHILE ENROUTE WITH VICTIM [REDACTED] TO THE SUSPECT
23 STOP LOCATION I ADVISED HER OF THE FOLLOWING - THE MAN
24 STOPPED MAY OR MAY NOT BE THE ROBBER, YOU ARE UNDER
25 NO OBLIGATION TO IDENTIFY ANYONE. TAKE YOUR TIME ->

4 REPORTED BY JANE E	5 BADGE 49	6 DIV 03	7 YRS OF SERVICE 15	8 DATE 3-24-94	9 APPROVED BY		
10 ASSISTED BY	11 BADGE	12 DIV	13 YRS OF SERVICE	14 TIME 0610	15 BADGE	16 DATE	17 TIME

- CRIME REPORT SUPPLEMENT
- MOTOR VEHICLE SUPPLEMENT
- COLLISION/TRAFFIC SUPPLEMENT
- INCIDENT REPORT SUPPLEMENT
- CASUALTY REPORT SUPPLEMENT
- MEMORANDUM

**SACRAMENTO POLICE DEPARTMENT
REPORT SUPPLEMENT**

1 REPORT NUMBER
94-24279

VICTIM OR COMPLAINANT

2 LAST NAME, FIRST, MIDDLE (FIRM NAME IF CRIME AGAINST BUSINESS) TACO BELL	3 CRIME CODE SECTION 211
--	------------------------------------

NARRATIVE

1	CONT'D
2	
3	→ AND BE SURE, IF YOUR NOT SURE JUST SAY THAT.
4	I ASKED [REDACTED] IF SHE UNDERSTOOD, SHE STATED
5	SHE DID.
6	
7	
8	
9	
10	
11	
12	
13	
14	
15	
16	
17	
18	
19	
20	
21	
22	
23	
24	
25	

4 REPORTED BY J. PINE III	5 BADGE 496	6 DIV 03	7 YRS OF SERVICE 15	8 DATE 5-21-90	9 APPROVED BY		
10 ASSISTED BY	11 BADGE	12 DIV	13 YRS OF SERVICE	14 TIME 0620	15 BADGE	16 DATE	17 TIME

- CRIME REPORT SUPPLEMENT
- MOTOR VEHICLE SUPPLEMENT
- COLLISION/TRAFFIC SUPPLEMENT
- INCIDENT REPORT SUPPLEMENT
- CASUALTY REPORT SUPPLEMENT
- MEMORANDUM

SACRAMENTO POLICE DEPARTMENT
REPORT SUPPLEMENT

1 REPORT NUMBER
94-24279

VICTIM OR COMPLAINANT	
2 LAST NAME, FIRST, MIDDLE (FIRM NAME IF CRIME AGAINST BUSINESS)	3 CRIME CODE SECTION

NARRATIVE

1	
2	0224 hrs. 032494 - Lt. Paroli # 4081 and
3	I, (Lt. Kelley # 4061) were in the field
4	in veh. # 6809. We heard police radio
5	advise of an armed robbery which
6	had just occurred at the Taco Bell
7	on Filson Blvd. Employees of the
8	Taco Bell had been robbed at gun point
9	by a suspect described as a male
10	black who fled in a "gun-metal"
11	colored Chevrolet bearing Lic. [REDACTED]
12	A registration check revealed the
13	vehicle to be registered to an address
14	in Southeast Sacramento
15	Lt. Paroli and I began looking
16	for the vehicle in the Oak Park area.
17	At 0251 hrs. we heard officer Schuele,
18	(K98) broadcast that he was behind
19	the robbery vehicle in the area of
20	9 Ave and MLK Blvd. We responded
21	from Broadway and 5 Ave. and saw
22	the robbery veh. and K-9-8 at MLK
23	and 7 Ave. A pursuit ensued
24	which terminated at Santa Rosa and
25	San Jose. When the robbery veh.

4 REPORTED BY	5 BADGE	6 DIV	7 YRS OF SERVICE	8 DATE	9 APPROVED BY
10 ASSISTED BY	11 BADGE	12 DIV	13 YRS OF SERVICE	14 TIME	15 BADGE
					16 DATE
					17 TIME

- CRIME REPORT SUPPLEMENT
- MOTOR VEHICLE SUPPLEMENT
- COLLISION/TRAFFIC SUPPLEMENT
- INCIDENT REPORT SUPPLEMENT
- CASUALTY REPORT SUPPLEMENT
- MEMORANDUM

SACRAMENTO POLICE DEPARTMENT
REPORT SUPPLEMENT

1 REPORT NUMBER
94-24279

VICTIM OR COMPLAINANT

2 LAST NAME, FIRST, MIDDLE (FIRM NAME IF CRIME AGAINST BUSINESS)	3 CRIME CODE SECTION
--	----------------------

NARRATIVE

1 Cont.

2 Stopped, a male black got out

3 of the left door and turned to

4 face officer Schuele who was exiting

5 his veh. The male black suspect of

6 the armed robbery had his hands in his

7 waist area when he faced officer Schuele.

8 I observed Schuele shoot one round

9 towards the suspect who then began

10 running south bound on San Jose. Believing

11 the suspect was armed, I moved to

12 a position in front of officer Schuele's

13 veh. and observed a clean line of fire

14 on the suspect who continued running S/B.

15 on San Jose. I fired four (4) shots

16 at the suspect who fell at the inter-

17 section of San Jose and 8 Ave. Officer

18 Schuele, Lt. Paroli, and I began foot

19 pursuit of the suspect, who got to

20 his feet and began running east on

21 8 Ave. The suspect was chased to the

22 rear yard of [REDACTED] 8 Ave. where he

23 was taken into custody by the three

24 of us. He was extremely physically resistive

25 during his capture.

4 REPORTED BY	5 BADGE	6 DIV	7 YRS OF SERVICE	8 DATE	9 APPROVED BY
10 ASSISTED BY	11 BADGE	12 DIV	13 YRS OF SERVICE	14 TIME	15 BADGE
					16 DATE
					17 TIME

Sgt. Ray

- CRIME REPORT SUPPLEMENT
- MOTOR VEHICLE SUPPLEMENT
- COLLISION/TRAFFIC SUPPLEMENT
- INCIDENT REPORT SUPPLEMENT
- CASUALTY REPORT SUPPLEMENT
- MEMORANDUM

SACRAMENTO POLICE DEPARTMENT
REPORT SUPPLEMENT

1 REPORT NUMBER
94-24279

VICTIM OR COMPLAINANT

2 LAST NAME, FIRST, MIDDLE (FIRM NAME IF CRIME AGAINST BUSINESS) 3 CRIME CODE SECTION
211 PC

NARRATIVE

1	OBSERVATIONS
2	
3	3-24-94 R/O D. SCHMIDT #287 WAS
4	WORKING UNIT K9-8. R/O WORKS
5	A POLICE SERVICE DOG FOR THE SACRAMENTO
6	POLICE DEPARTMENT. THE CANINE'S NAME
7	IS LIZ. R/O WORKS IN UNIFORM AND
8	DRIVES A MARKED SQUAD CAR.
9	
10	AT 0245 HRS R/O HEARD A RADIO BROAD-
11	CAST THAT A ROBBERY HAD JUST
12	OCCURRED AT 5625 FOLSOM BLVD (THE
13	TACO BELL). THE SUSPECT WAS
14	A M/B DRIVING AN 85 CHEV (4-0002)
15	WITH THE LICENSE PLATE OF [REDACTED]
16	A REGISTRATION CHECK SHOWED THE
17	ADDRESS OF [REDACTED]
18	
19	R/O BEGAN LOOKING FOR THE SUSPECT
20	AND SUSPECT VEHICLE IN THE OAK
21	PARK AREA. AT 0251 HRS R/O
22	OBSERVED A GREY CHEV^(H-09) DRIVING
23	S/B 3RD FROM APPROX 3 RD W/.
24	THE^{VEHICLE} CONTINUED S/B AND R/O TURNED
25	HIS VEHICLE AROUND IN AN ATTEMPT

4 REPORTED BY D. Schmidt	5 BADGE 287	6 DIV 07	7 YRS OF SERVICE	8 DATE 3/24	9 APPROVED BY <i>[Signature]</i>
10 ASSISTED BY	11 BADGE	12 DIV	13 YRS OF SERVICE	14 TIME	15 BADGE 2096
					16 DATE 3-24-94
					17 TIME 0535

- CRIME REPORT SUPPLEMENT
- MOTOR VEHICLE SUPPLEMENT
- COLLISION/TRAFFIC SUPPLEMENT
- INCIDENT REPORT SUPPLEMENT
- CASUALTY REPORT SUPPLEMENT
- MEMORANDUM

SACRAMENTO POLICE DEPARTMENT
REPORT SUPPLEMENT

1 REPORT NUMBER
94-24279

VICTIM OR COMPLAINANT

2 LAST NAME, FIRST, MIDDLE (FIRM NAME IF CRIME AGAINST BUSINESS) 3 CRIME CODE SECTION
211E

NARRATIVE

1 OBSERVATIONS (CONT'D)

2

3 TO SEE THE LICENSE PLATE. THE

4 CHEV ACCELERATED HEAVILY AND CONTINUED

5 SIB 3RD STREET. P/O ADVISED RADIO

6 THAT HE WAS FOLLOWING A POSSIBLE

7 Q11 VEHICLE. THE SUSPECT VEHICLE

8 TURNED EAST BOUND ON 7TH AVE AND

9 P/O WAS ABLE TO CONFIRM THE PLATE

10 WAS IN FACT [REDACTED] P/O

11 ACTIVATED HIS VEHICLE'S OVERHEAD

12 RED/BLUE LIGHTS AND SOUNDED AS IT

13 WAS OBVIOUS THE SUSPECT VEHICLE

14 KNEW P/O WAS BEHIND IT AND IT

15 WAS FLEEING. THE VEHICLE CONTINUED

16 EAST BOUND 7TH AVE AT APPROX 65-70

17 MPH ACROSS MARTIN LUTHER KING -

18 TURNED SIB MARTIN LUTHER KING

19 THEN TURNED QUICKLY EAST BOUND

20 EIGHT AVE. THE SUSPECT VEHICLE

21 CONTINUED ON EIGHT AVE, THEN

22 TURNED NORTH BOUND 42ND ST.

23 THE VEHICLE LEFT THE ROADWAY -

24 STRIKING A TREE ON THE EAST

25 CURBLINE. THE SUSPECT VEHICLE

4 REPORTED BY D. Smith	5 BADGE 287	6 DIV 07	7 YRS OF SERVICE	8 DATE 3/24	9 APPROVED BY <i>[Signature]</i>
10 ASSISTED BY	11 BADGE	12 DIV	13 YRS OF SERVICE	14 TIME	15 BADGE 3016 16 DATE 3/24/94 17 TIME 0535

- CRIME REPORT SUPPLEMENT
- MOTOR VEHICLE SUPPLEMENT
- COLLISION/TRAFFIC SUPPLEMENT
- INCIDENT REPORT SUPPLEMENT
- CASUALTY REPORT SUPPLEMENT
- MEMORANDUM

SACRAMENTO POLICE DEPARTMENT
REPORT SUPPLEMENT

1 REPORT NUMBER
94-24279

VICTIM OR COMPLAINANT

2 LAST NAME, FIRST, MIDDLE (FIRM NAME IF CRIME AGAINST BUSINESS)	3 CRIME CODE SECTION 211 PC
--	---------------------------------------

NARRATIVE

1	OBSERVATIONS (CONT'D)
2	
3	CONTINUED NORTH BOUND ON 42 ND ST,
4	TURNING W/B ON SANTA ROSA.
5	THE VEHICLE ATTEMPTED TO TURN
6	FROM SANTA ROSA TO SIB SAND
7	DISE. THE VEHICLE WAS UNABLE
8	TO MAKE THE TURN AND STRUCK
9	A RAISED SIDEWALK, COMING TO A
10	STOP.
11	
12	R/O SAW THE DRIVER OPEN THE
13	DRIVER'S SIDE DOOR AND START
14	TO EXIT THE VEHICLE. THE DRIVER
15	LOOKED BACK AND TURNED HIS
16	BODY AROUND TO FACE R/O, WHILE
17	DROPPING HIS RIGHT HAND TO HIS
18	BELT AS IF TO GRAB A WEAPON.
19	R/O SAW THIS AND FELT HIS LIFE
20	THE LIVES OF ASSISTING OFFICERS WAS
21	IN IMMEDIATE DANGER AS A PISTOL
22	WAS USED IN THE ROBBERY AND
23	THE WAIST BAND AREA IS A
24	COMMON PLACE TO CARRY A HAND-
25	GUN. R/O DREW HIS SERVICE

4 REPORTED BY D. Schwan	5 BADGE 207	6 DIV 07	7 YRS OF SERVICE	8 DATE	9 APPROVED BY <i>[Signature]</i>
10 ASSISTED BY	11 BADGE	12 DIV	13 YRS OF SERVICE	14 TIME	15 BADGE 3096
					16 DATE 3-24-94
					17 TIME 0535

- CRIME REPORT SUPPLEMENT
- MOTOR VEHICLE SUPPLEMENT
- COLLISION/TRAFFIC SUPPLEMENT
- INCIDENT REPORT SUPPLEMENT
- CASUALTY REPORT SUPPLEMENT
- MEMORANDUM

SACRAMENTO POLICE DEPARTMENT
REPORT SUPPLEMENT

1 REPORT NUMBER
94-24279

VICTIM OR COMPLAINANT

2 LAST NAME, FIRST, MIDDLE (FIRM NAME IF CRIME AGAINST BUSINESS)	3 CRIME CODE SECTION 211 PC
--	--------------------------------

NARRATIVE

1	OBSERVATIONS (CONT'D)
2	
3	WEAPON AND FIRED 1 ROUND AT
4	THE SUSPECT. AT APPROX THE
5	SAME TIME, P/O HEARD OFFICERS)
6	(WATER ID'ED AS LT. FOLLEY) FIRE A
7	COUPLE ADDITIONAL ROUNDS. THE
8	SUSPECT CONTINUES S/B ON SAND
9	SOLE, FALLING AT THE LAST CORNER.
10	(JUST TRIPPED NOT WOUNDED) THE SUSPECT
11	GOT UP AND CONTINUES RUNNING EAST
12	ON 8th AVE, WITH P/O, LT FOLLEY AND LT
13	POZOLE IN FOOT PURSUIT.
14	
15	THE SUSPECT JUMPED OVER A WOODEN
16	FENCE AT [REDACTED] 8th AVE AND WENT
17	INTO THE BACK-YARD. ALL THREE
18	OFFICERS CAUGHT TO HIM AND REPEATEDLY
19	ORDERED THE SUSPECT TO STOP & GOT
20	ON THE GROUND AND HE REFUSED.
21	THE SUSPECT WAS FORCED TO THE
22	GROUND WHERE HE CONTINUED TO
23	PUNCH AT AND KICK AT OFFICERS.
24	P/O STRUCK THE SUSPECT 3-5 TIMES
25	IN THE RIGHT KNEE AREA TO GAIN

4 REPORTED BY D. Schulte	5 BADGE 267	6 DIV 07	7 YRS OF SERVICE	8 DATE	9 APPROVED BY B. Cordell Ford
10 ASSISTED BY	11 BADGE	12 DIV	13 YRS OF SERVICE	14 TIME	15 BADGE 3016
					16 DATE 3-21-94
					17 TIME 0535

- CRIME REPORT SUPPLEMENT
- MOTOR VEHICLE SUPPLEMENT
- COLLISION/TRAFFIC SUPPLEMENT
- INCIDENT REPORT SUPPLEMENT
- CASUALTY REPORT SUPPLEMENT
- MEMORANDUM

SACRAMENTO POLICE DEPARTMENT
REPORT SUPPLEMENT

1 REPORT NUMBER 94-24279

VICTIM OR COMPLAINANT

2 LAST NAME, FIRST, MIDDLE (FIRM NAME IF CRIME AGAINST BUSINESS)	3 CRIME CODE SECTION
--	----------------------

NARRATIVE

1	OBSERVATIONS (CONT'D)
2	
3	
4	CONTROL AND OVER CAME THE SUSPECTS
5	AGGRESSION. THE SUSPECT WAS
6	FINALLY HANDCUFFED. ASSISTING UNITS
7	ARRIVED ON THE SCENE & TOOK CHARGE
8	OF THE SUSPECT. THE SUSPECT WAS
9	CHECKED AND NO BULLET WOUNDS WERE
10	OBSERVED.
11	
12	Ⓢ NOTE OUT OF ORDER Ⓢ
13	
14	DURING THE PURSUIT, R/O'S CAMINO
15	LET WAS THROWN FROM THE VEHICLE
16	DUE TO THE FORCE OF A TURN.
17	LET WAS LATER RECOVERED IN THE
18	AREA UNHURT.
19	
20	
21	
22	
23	
24	
25	

4 REPORTED BY <i>D. Moore</i>	5 BADGE <i>267</i>	6 DIV <i>07</i>	7 YRS OF SERVICE	8 DATE	9 APPROVED BY <i>H. Cordell Ford</i>
10 ASSISTED BY	11 BADGE	12 DIV	13 YRS OF SERVICE	14 TIME	15 BADGE <i>3076</i>
					16 DATE <i>3-21-94</i>
					17 TIME <i>0535</i>

- CRIME REPORT SUPPLEMENT
- MOTOR VEHICLE SUPPLEMENT
- COLLISION/TRAFFIC SUPPLEMENT
- INCIDENT REPORT SUPPLEMENT
- CASUALTY REPORT SUPPLEMENT
- MEMORANDUM

SACRAMENTO POLICE DEPARTMENT
REPORT SUPPLEMENT

1 REPORT NUMBER
94-24279

VICTIM OR COMPLAINANT

2 LAST NAME, FIRST, MIDDLE (FIRM NAME IF CRIME AGAINST BUSINESS)	3 CRIME CODE SECTION 211 P.C.
--	---

NARRATIVE

1	
2	Observations!
3	
4	Approx. 0315 hrs I inspected the
5	dept. issue 9MM Sig Sauer hand-
6	guns carried by Ofcr. Schiele
7	and Lt. Kelley. Both appeared to
8	be in good working order.
9	
10	Ofcr. Schiele's weapon had one(1)
11	live round in the chamber and fourteen
12	live rounds in the magazine.
13	
14	Lt. Kelley's weapon had one(1) live
15	round in the chamber and eleven(11)
16	live rounds in the magazine.
17	
18	
19	
20	
21	
22	
23	
24	
25	

4 REPORTED BY [Signature]	5 BADGE 4057	6 DIV 01	7 YRS OF SERVICE 21	8 DATE 3/21/94	9 APPROVED BY [Signature]		
10 ASSISTED BY [Signature]	11 BADGE	12 DIV	13 YRS OF SERVICE	14 TIME	15 BADGE	16 DATE	17 TIME

**SACRAMENTO POLICE DEPARTMENT
PHOTOGRAPHIC AND EVIDENCE REPORT**

CRIME CLASS 211 PC.	LOG NUMBER 182-1	REPORT NUMBER 94-24279
COMPLAINANT OR VICTIM TARO BELL	ADDRESS WORK PERFORMED SANTA ROSA / SAN JOSE	
PHOTOGRAPHS (ALPHABETICAL) TO _____	ELIMINATION PRINTS: YES <input type="checkbox"/> NO <input checked="" type="checkbox"/>	EVIDENCE (NUMERICAL) TO _____

P	E	NARRATIVE
		03-24-94 APPROX 0300 HRS. I R/O YAGER RECEIVED A CALL AT HOME, TO RESPOND TO AN OFFICER INVOLVED SHOOTING, AT SANTA ROSA AND SAN JOSE.
		APPROX ARRIVAL TIME OF 0345 HRS. OFFICERS ON THE SCENE WERE K-98 SCHIELE 0287 AND LTS. KELLY AND DOROLI AND PEIFFER. AT LT. PEIFFER'S REQUEST I PROCESSED THE SCENE FOR PHYSICAL EVIDENCE WITH THE FOLLOWING RESULTS:
		<u>COLOR PHOTOGRAPHS: 6</u>
		(2) TWO ROLLS TAKEN OF THE SCENE & EVIDENCE.
		<u>PHYSICAL EVIDENCE: LOCKER # 6</u>
1	5	9MM EMPTY SHELL CASINGS (SEE DIAGRAM)
6		TORN NYLON SOCKS. OBSERVED ON R/FRONT FLOOR OF VEH A (SUSPECT VEH)
7		BLK PLASTIC TOY GUN. - OBSERVED WEDGED BETWEEN THE R/FRONT SEAT & CONSOLE SUSPECT VEHICLE.

REPORTING OFFICER/S YAGER	YEARS OF SERVICE 23	BADGE # 085	UNIT CS16	DATE 3-24-94	TIME 0300
-------------------------------------	-------------------------------	-----------------------	---------------------	------------------------	---------------------

**SACRAMENTO POLICE DEPARTMENT
PHOTOGRAPHIC AND EVIDENCE REPORT**

CRIME CLASS 211 PC.	LOG NUMBER 132-1	REPORT NUMBER 4-24279
COMPLAINANT OR VICTIM TARO BELL	ADDRESS WORK PERFORMED SANJA ROSA / SAN JOSE	
PHOTOGRAPHS (ALPHABETICAL) TO _____	ELIMINATION PRINTS: <input type="checkbox"/> YES <input checked="" type="checkbox"/> NO	EVIDENCE (NUMERICAL) TO _____

P	E	NARRATIVE
		<u>CONT.</u>
		<u>PHYSICAL EVIDENCE: Locker # 6</u>
	8	DARK BLUE HAT
	9	BLK NYLON JACKET.
	11	7-11 MATCHES.
	12	PARTIAL PKG "PREMIUM BUY" CIGARETTES
	13	4-DOLLARS BILLS.
	14	TARO BELL PAPER BAG - CONTAINING A WRAPPED UNEATEN BEAN BURRITO (DISCARDED)
		NOTE: ITEMS 8-14 - OBSERVED ON THE R/FRONT SEAT ITEMS 11-12-13 WERE IN THE R/FRONT POCKET OF ITEM #19
	15	LONG SLEEVE PINK SWEAT SHIRT
	16	TORN PURPLE JOCKEY SHORTS
	17	BLACK "CAMPUS" COAT
		NOTE: ITEMS 15-16-17 FOUND ON THE REAR SEAT

REPORTING OFFICER/S L. VASQUEZ	YEARS OF SERVICE 23	BADGE # 0485	UNIT CS116	DATE 3-24-94	TIME 0300
--	-------------------------------	------------------------	----------------------	------------------------	---------------------

SACRAMENTO POLICE DEPARTMENT
PHOTOGRAPHIC AND EVIDENCE REPORT

CRIME CLASS <u>211 P.C.</u>	LOG NUMBER <u>172-1</u>	REPORT NUMBER <u>94-24279</u>
COMPLAINANT OR VICTIM <u>TACO BELL</u>	ADDRESS WORK PERFORMED <u>SANTA ROSA / SAN JOSE</u>	
PHOTOGRAPHS (ALPHABETICAL) TO	ELIMINATION PRINTS: <input type="checkbox"/> YES <input checked="" type="checkbox"/> NO	EVIDENCE (NUMERICAL) TO

P	E	NARRATIVE
		<u>CONT.</u>
		<u>PHYSICAL EVIDENCE</u> <u>LOOKING</u>
18		"CRACK" PIPE - OBSERVED R/FRONT FLOOR BOARDS
19		PLASTIC BOTTLE W/GARLIC SALT. OBSERVED ON THE CENTER CONSOLE
20		SPENT LEAD SLUG REMOVED FROM TELEPHONE DOLBY # 051 - S/EAST CORNER OF SANTA ROSA + SAN JOSE - APPROX 12" UP FROM GROUND LEVEL

REPORTING OFFICER/S <u>LN YAGN</u>	YEARS OF SERVICE <u>23</u>	BADGE # <u>0485</u>	UNIT <u>13116</u>	DATE <u>3-24-94</u>	TIME <u>0300</u>
---------------------------------------	-------------------------------	------------------------	----------------------	------------------------	---------------------

SACRAMENTO POLICE DEPARTMENT
DIAGRAM AND PHYSICAL EVIDENCE SHEET

PAGE 4 OF 10

CLASS. 211PC

REPORT NUMBER
94-24279

VICTIM _____ LOCATION SANTA ROSA / SAN JOSE

ALL MEASUREMENTS ARE APPROXIMATE AND NOT TO SCALE UNLESS STATED (SCALE _____)

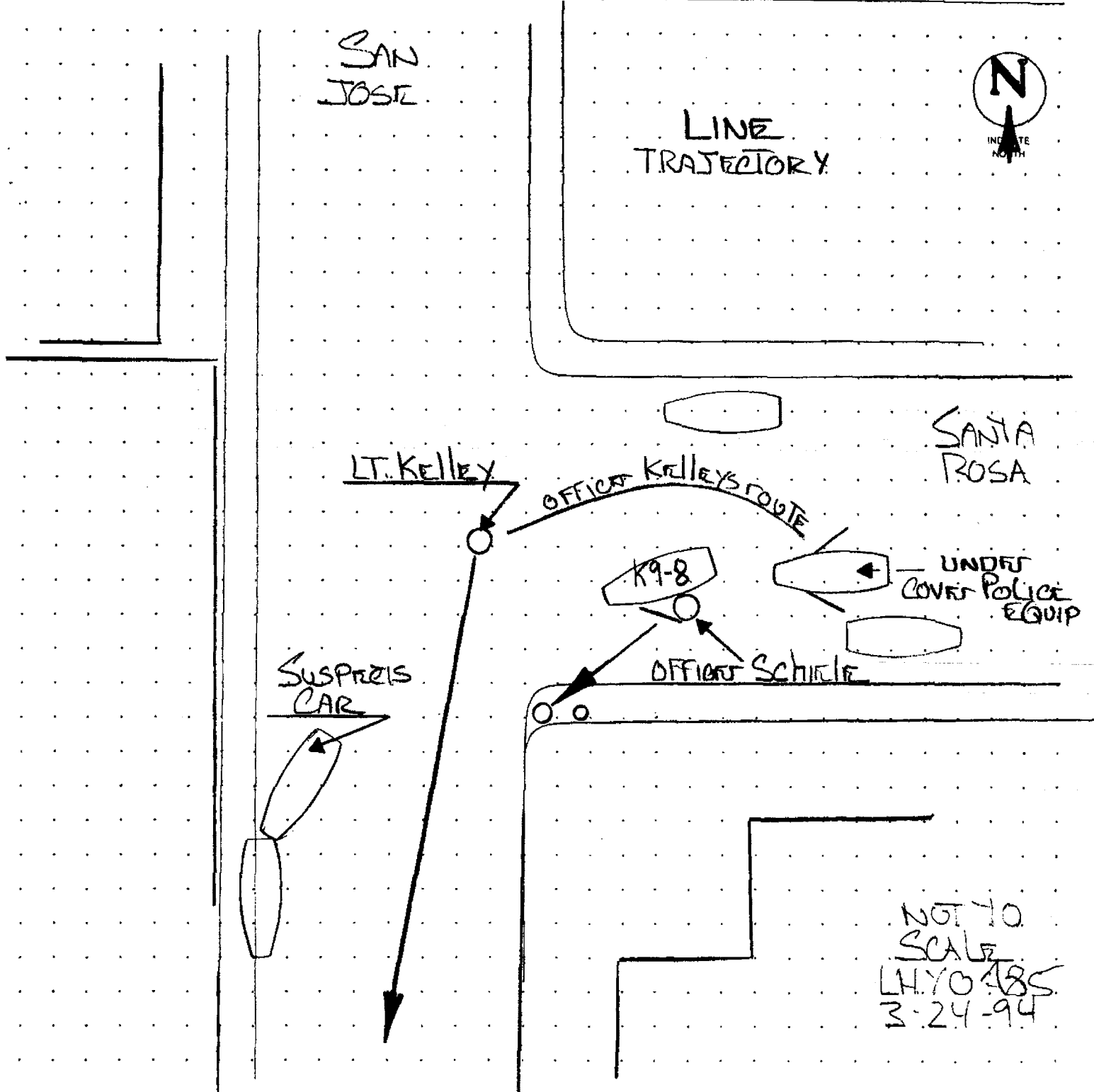

PREPARED BY <u>LH YAGUJ</u>	BADGE <u>042508</u>	DIV	DATE <u>3-24-94</u>	APPROVED BY
ASSISTING OFFICER	BADGE	DIV	TIME	BADGE DATE TIME

SACRAMENTO POLICE DEPARTMENT
 DIAGRAM AND PHYSICAL EVIDENCE SHEET

PAGE 5 OF 10

CLASS. 211PC

REPORT NUMBER 94-24279

VICTIM _____ LOCATION SANTA ROSA / SAN JOSE

ALL MEASUREMENTS ARE APPROXIMATE AND NOT TO SCALE UNLESS STATED (SCALE _____)

SAN JOSE



D

SANTA ROSA

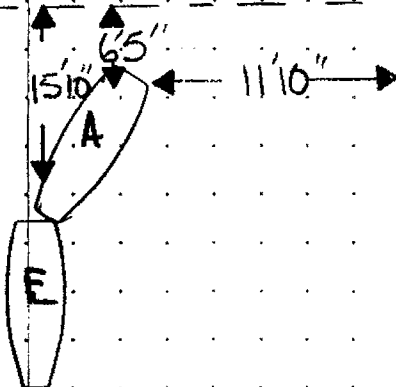
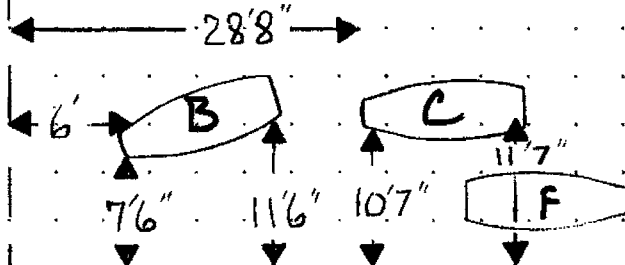

NOT TO SCALE
 LHYO:BS
 3-24-94

PREPARED BY <u>LHYAGTJ</u>	BADGE <u>048508</u>	DIV	DATE <u>3-24-94</u>	APPROVED BY
ASSISTING OFFICER	BADGE	DIV	TIME	BADGE DATE TIME

SACRAMENTO POLICE DEPARTMENT
 DIAGRAM AND PHYSICAL EVIDENCE SHEET

PAGE 6 OF 10

CLASS. 211PC

REPORT NUMBER 94-24279

VICTIM _____ LOCATION SANTA ROSA / SAN JOSE

ALL MEASUREMENTS ARE APPROXIMATE AND NOT TO SCALE UNLESS STATED (SCALE)

- VEHICLES:
- A. 4 DR. GREY CHEVROLET
 - B. POLICE EQUIP 72389 E373469
 - C. 4 DR. BROWN FORD
 - D. WHT FORD PROBE
 - E. 4 DR. GREY RENAULT
 - F. BUN FORD RANCHERO

SAN JOSE



SANTA ROSA



NOT TO SCALE
 LH:Y0485
 3-24-94

PREPARED BY LH:YAGU	BADGE 048508	DIV	DATE 3-24-94	APPROVED BY
ASSISTING OFFICER	BADGE	DIV	TIME	BADGE DATE TIME

SACRAMENTO POLICE DEPARTMENT
DIAGRAM AND PHYSICAL EVIDENCE SHEET

PAGE 7 OF 10

CLASS. 211PC

REPORT NUMBER
94-24279

VICTIM _____ LOCATION SANTA ROSA / SAN JOSE

ALL MEASUREMENTS ARE APPROXIMATE AND NOT TO SCALE UNLESS STATED (SCALE _____)

EVIDENCE:

- 1. 9MM
SHELL CASING
- 2. 9MM
SHELL CASING
- 3. 9MM
SHELL CASING
- 4. 9MM
SHELL CASING
- 5. 9MM
SHELL CASING

SAN
JOSE

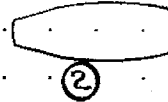

SANTA
ROSA

5

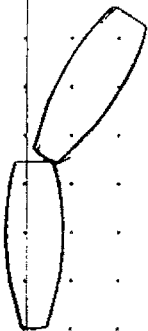
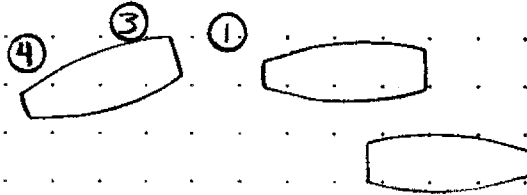

NOT TO
SCALE
LH.YO:BS
3-24-94

PREPARED BY <u>LH YAGUJ</u>	BADGE <u>048508</u>	DIV	DATE <u>3-24-94</u>	APPROVED BY
ASSISTING OFFICER	BADGE	DIV	TIME	BADGE DATE TIME

SACRAMENTO POLICE DEPARTMENT
 DIAGRAM AND PHYSICAL EVIDENCE SHEET

PAGE 8 OF 10

CLASS. 211PC

REPORT NUMBER 94-24279

VICTIM _____ LOCATION SANTA ROSA / SAN JOSE

ALL MEASUREMENTS ARE APPROXIMATE AND NOT TO SCALE UNLESS STATED (SCALE -)

PHYSICAL EVIDENCE 1

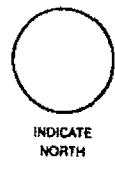

1. 9mm SIGEL CASING BRASS LUGER
 26'10" E OF EAST CURB OF SAN JOSE
 17'10" N OF SOUTH CURB OF SANTA ROSA
2. 9mm SIGEL CASING BRASS LUGER
 21'10" E OF EAST CURB OF SAN JOSE
 24' N OF SOUTH CURB OF SANTA ROSA
3. 9mm SIGEL CASING BRASS LUGER
 18'4" E OF EAST CURB OF SAN JOSE
 17'2" N OF SOUTH CURB OF SANTA ROSA
4. 9mm SIGEL CASING BRASS LUGER
 18' E OF EAST CURB OF SAN JOSE
 13'5" N OF SOUTH CURB OF SANTA ROSA
5. 9mm SIGEL CASING BRASS LUGER
 10'7" E OF WEST CURB OF SAN JOSE
 12'10" N OF SOUTH CURB OF SANTA ROSA

PREPARED BY <u>LH VAGOT</u>	BADGE <u>08508</u>	DIV <u>08</u>	DATE <u>3-24-94</u>	APPROVED BY
ASSISTING OFFICER	BADGE	DIV	TIME	BADGE DATE TIME

SACRAMENTO POLICE DEPARTMENT
 DIAGRAM AND PHYSICAL EVIDENCE SHEET

PAGE 9 of 10

CLASS. 211PC

REPORT NUMBER 94-24279

VICTIM _____ LOCATION SANTA ROSA / SAN JOSE

ALL MEASUREMENTS ARE APPROXIMATE AND NOT TO SCALE UNLESS STATED (SCALE _____)

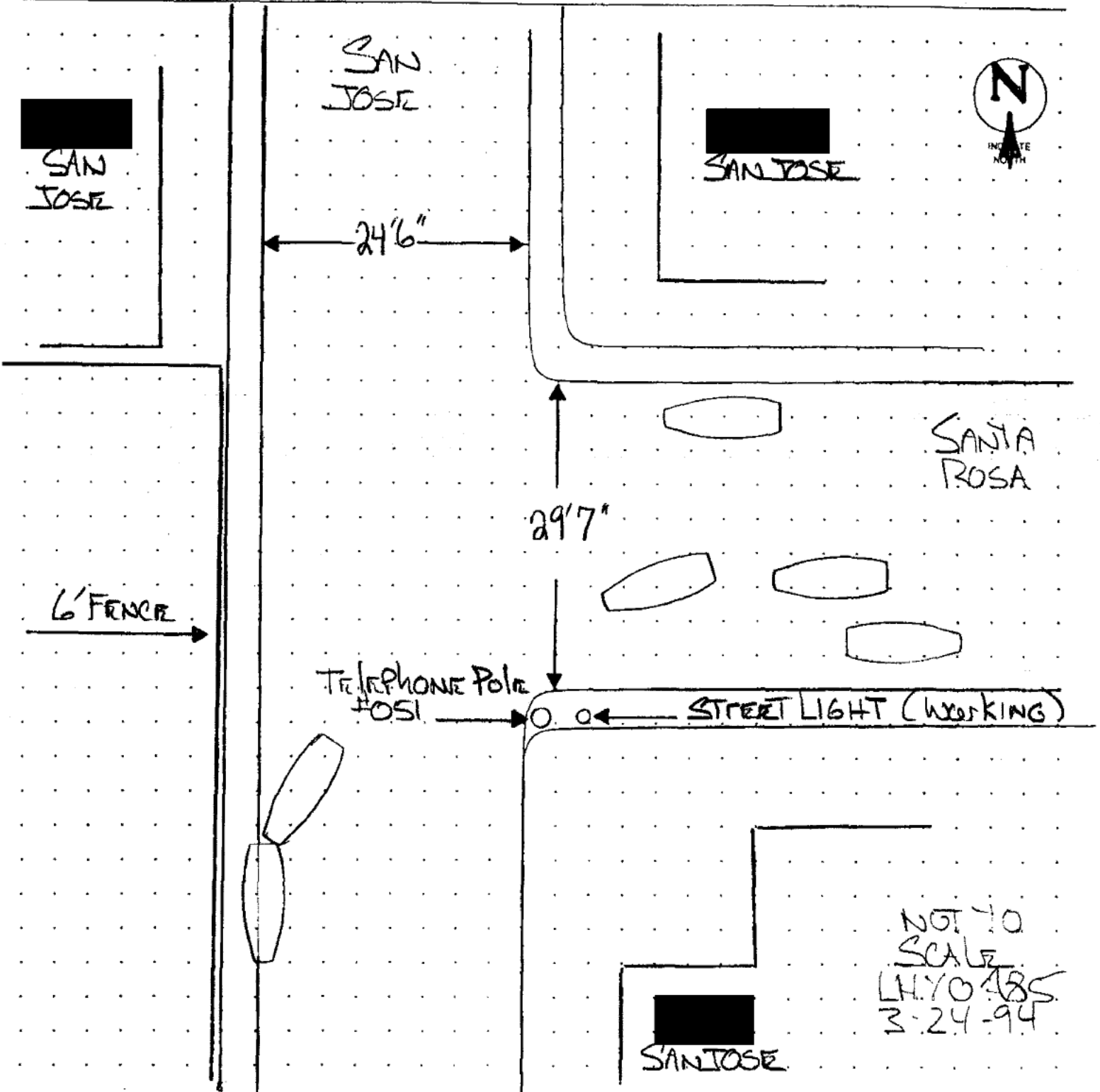

PREPARED BY LH:YAG:J	BADGE 042808	DIV	DATE 3-24-94	APPROVED BY
ASSISTING OFFICER	BADGE	DIV	TIME	BADGE DATE TIME

29

3-24-94

20

11-27-17

21

29

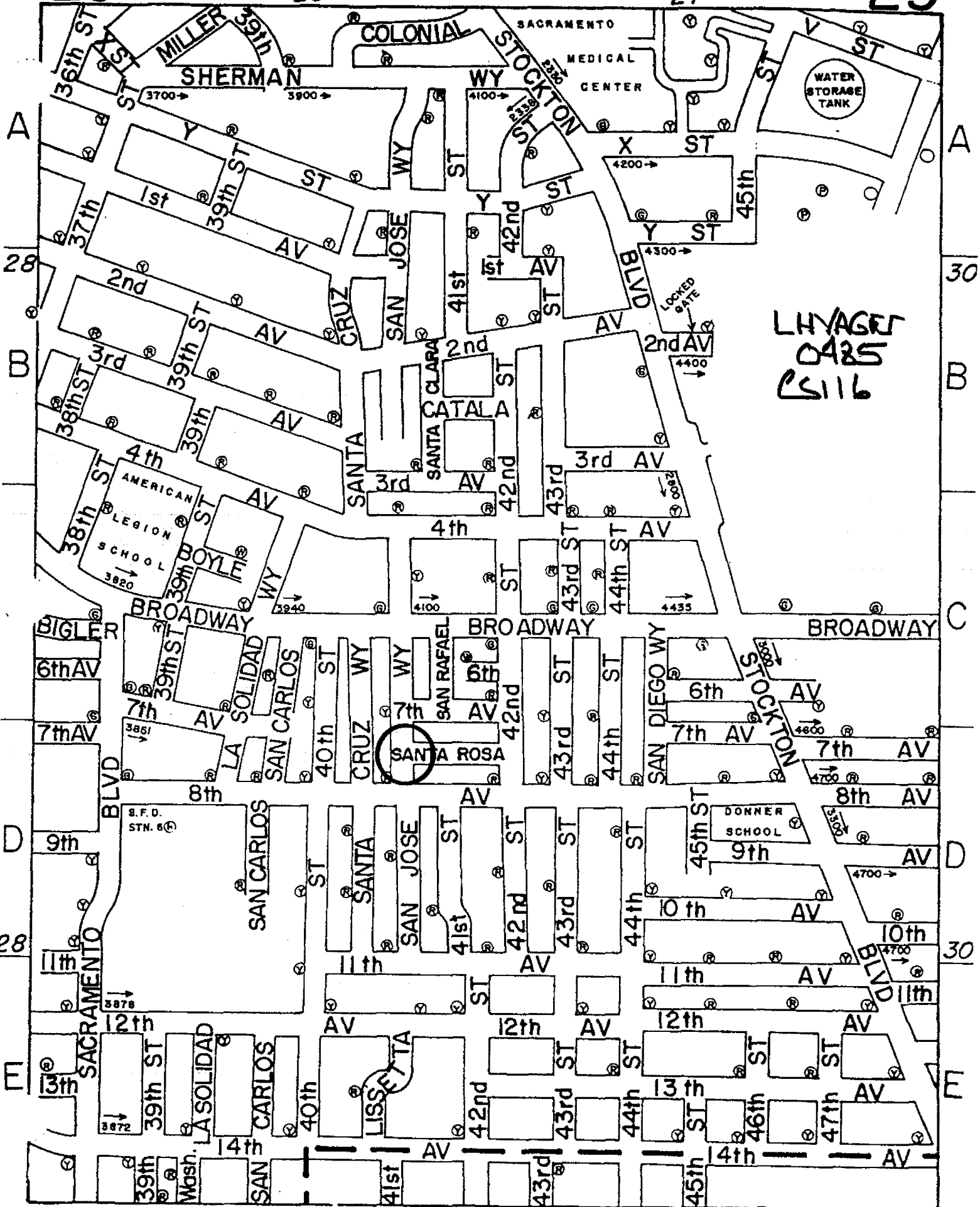

LHYAGES
0425
CS116

SANTA ROSA

**SACRAMENTO POLICE DEPARTMENT
OFFICER'S BOOKING AND FIELD RECEIPT**

SUPPLEMENTAL PAGE

13192

LOCKERS USED 6 CHARGE(S) 211 PC REPORT # 94-24279
 NARCO/MONEY BOOKING CITATION # _____
 LARGE PROPERTY BOOKING SEARCH WARRANT # _____
 LOCATION OF OCCURRENCE SANTA ROSA/SAN JOSE PREVIOUS BOOKING PR # _____
 VICTIM: _____ DEFENDANT: _____

REPORTING OFFICER	BADGE #	DIV	RECEIVED DATE	TIME	IN LOCKER DATE	TIME	
LYAGOR	0485	08	3-24-94	0400	3-24-94	0930	
DESCRIBE PROPERTY BELOW IN THE FOLLOWING SEQUENCE: ITEM TYPE NO-PIECES - COLOR - BRAND - MOD - SER - QAN - DESCRIPTION - CALIBER - MONEY AMOUNT - BLADE/BARREL/OVERALL LENGTH						CRIME LAB	PRINT
ITEM # 9	BK Nylon Jacket	<input checked="" type="checkbox"/> OWNER <input type="checkbox"/> TKN FROM <input type="checkbox"/> CO-HAB	Suspect	DOB SS # OLN	YES <input type="checkbox"/> NO <input checked="" type="checkbox"/>	YES <input type="checkbox"/> NO <input checked="" type="checkbox"/>	BoBo21402 Property use only
ITEM # 10	Eye Glasses	<input checked="" type="checkbox"/> OWNER <input type="checkbox"/> TKN FROM <input type="checkbox"/> CO-HAB	Suspect	DOB SS # OLN	YES <input type="checkbox"/> NO <input checked="" type="checkbox"/>	YES <input type="checkbox"/> NO <input checked="" type="checkbox"/>	Property use only
ITEM # 11	7-11 MATCHES	<input checked="" type="checkbox"/> OWNER <input type="checkbox"/> TKN FROM <input type="checkbox"/> CO-HAB	Suspect	DOB SS # OLN	YES <input type="checkbox"/> NO <input checked="" type="checkbox"/>	YES <input type="checkbox"/> NO <input checked="" type="checkbox"/>	Property use only
ITEM # 12	partial pkg premium box cigarettes	<input checked="" type="checkbox"/> OWNER <input type="checkbox"/> TKN FROM <input type="checkbox"/> CO-HAB	Suspect	DOB SS # OLN	YES <input type="checkbox"/> NO <input checked="" type="checkbox"/>	YES <input type="checkbox"/> NO <input checked="" type="checkbox"/>	Property use only
ITEM # 13	4 - Dollar Bills	<input checked="" type="checkbox"/> OWNER <input type="checkbox"/> TKN FROM <input type="checkbox"/> CO-HAB	Suspect	DOB SS # OLN	YES <input type="checkbox"/> NO <input checked="" type="checkbox"/>	YES <input type="checkbox"/> NO <input checked="" type="checkbox"/>	BoBo21402 Property use only
ITEM # 14	TARO Bell BIG w/napkin	<input checked="" type="checkbox"/> OWNER <input type="checkbox"/> TKN FROM <input type="checkbox"/> CO-HAB	Suspect	DOB SS # OLN	YES <input type="checkbox"/> NO <input checked="" type="checkbox"/>	YES <input type="checkbox"/> NO <input checked="" type="checkbox"/>	Property use only
ITEM # 15	PINK long sleeve sweat shirt	<input checked="" type="checkbox"/> OWNER <input type="checkbox"/> TKN FROM <input type="checkbox"/> CO-HAB	Suspect	DOB SS # OLN	YES <input type="checkbox"/> NO <input checked="" type="checkbox"/>	YES <input type="checkbox"/> NO <input checked="" type="checkbox"/>	Property use only
ITEM # 16	Dark Purple Jockey shorts	<input checked="" type="checkbox"/> OWNER <input type="checkbox"/> TKN FROM <input type="checkbox"/> CO-HAB	Suspect	DOB SS # OLN	YES <input type="checkbox"/> NO <input checked="" type="checkbox"/>	YES <input type="checkbox"/> NO <input checked="" type="checkbox"/>	Property use only
ITEM # 17	Black Campus coat	<input checked="" type="checkbox"/> OWNER <input type="checkbox"/> TKN FROM <input type="checkbox"/> CO-HAB	Suspect	DOB SS # OLN	YES <input type="checkbox"/> NO <input checked="" type="checkbox"/>	YES <input type="checkbox"/> NO <input checked="" type="checkbox"/>	Property use only
ITEM # 18	"CARK" PAPER	<input checked="" type="checkbox"/> OWNER <input type="checkbox"/> TKN FROM <input type="checkbox"/> CO-HAB	Suspect	DOB SS # OLN	YES <input type="checkbox"/> NO <input checked="" type="checkbox"/>	YES <input type="checkbox"/> NO <input checked="" type="checkbox"/>	BoBo21402 Property use only

PRINT

OFFICER Lyagor 0485 CITIZEN _____ DATE _____

SIGNATURE AND BADGE NUMBER

IF FIELD RECEIPT, HAVE CITIZEN SIGN

WHITE PROPERTY 0485 WHITE PROPERTY 0485
 ON/6332
 3/25/94

3 PINK - INVESTIGATIONS 4 GOLDENROD - FIELD RECEIPT
 PAGE 2 OF 3

**SACRAMENTO POLICE DEPARTMENT
OFFICER'S BOOKING AND FIELD RECEIPT**

SUBMINAL 101

LOCKERS USED 6 CHARGE(S) 211 PC REPORT # 94-24279
 NARCO/MONEY BOOKING CITATION # _____
 LARGE PROPERTY BOOKING SEARCH WARRANT # _____
 LOCATION OF OCCURRENCE Santa Rosa / San Jose PREVIOUS BOOKING PR # _____
 VICTIM: TREO BELL DEFENDANT: _____

4431920

REPORTING OFFICER	BADGE #	DIV	RECEIVED DATE	TIME	IN LOCKER DATE	TIME		
<u>L. H. GARDNER</u>	<u>0485</u>	<u>08</u>	<u>3-24-94</u>	<u>0400</u>	<u>3-24-94</u>	<u>0900</u>		
DESCRIBE PROPERTY BELOW IN THE FOLLOWING SEQUENCE: ITEM TYPE NO - PIECES - COLOR - BRAND - MOD - SER - QAN - DESCRIPTION - CALIBER - MONEY AMOUNT - BLADE/BARREL/OVERALL LENGTH						CRIME LAB	PRINT	
ITEM # <u>19</u>	<u>Plastic Bottle / Gunie Salt</u>					<input checked="" type="checkbox"/> OWNER <input type="checkbox"/> TKN FROM <input type="checkbox"/> CO-HAB	NAME ADDRESS DOB SS # OLN <u>SUSPECT</u>	YES <input type="checkbox"/> NO <input checked="" type="checkbox"/> YES <input type="checkbox"/> NO <input checked="" type="checkbox"/> <u>B08021402</u> Property use only
ITEM # <u>20</u>	<u>SPENT lead slug</u>					<input type="checkbox"/> OWNER <input type="checkbox"/> TKN FROM <input type="checkbox"/> CO-HAB	NAME ADDRESS DOB SS # OLN <u>SPD</u>	YES <input type="checkbox"/> NO <input checked="" type="checkbox"/> YES <input type="checkbox"/> NO <input checked="" type="checkbox"/> <u>B08021402</u> Property use only
ITEM #						<input type="checkbox"/> OWNER <input type="checkbox"/> TKN FROM <input type="checkbox"/> CO-HAB	NAME ADDRESS DOB SS # OLN	YES <input type="checkbox"/> NO <input type="checkbox"/> YES <input type="checkbox"/> NO <input type="checkbox"/> Property use only
ITEM #						<input type="checkbox"/> OWNER <input type="checkbox"/> TKN FROM <input type="checkbox"/> CO-HAB	NAME ADDRESS DOB SS # OLN	YES <input type="checkbox"/> NO <input type="checkbox"/> YES <input type="checkbox"/> NO <input type="checkbox"/> Property use only
ITEM #						<input type="checkbox"/> OWNER <input type="checkbox"/> TKN FROM <input type="checkbox"/> CO-HAB	NAME ADDRESS DOB SS # OLN	YES <input type="checkbox"/> NO <input type="checkbox"/> YES <input type="checkbox"/> NO <input type="checkbox"/> Property use only
ITEM #						<input type="checkbox"/> OWNER <input type="checkbox"/> TKN FROM <input type="checkbox"/> CO-HAB	NAME ADDRESS DOB SS # OLN	YES <input type="checkbox"/> NO <input type="checkbox"/> YES <input type="checkbox"/> NO <input type="checkbox"/> Property use only
ITEM #						<input type="checkbox"/> OWNER <input type="checkbox"/> TKN FROM <input type="checkbox"/> CO-HAB	NAME ADDRESS DOB SS # OLN	YES <input type="checkbox"/> NO <input type="checkbox"/> YES <input type="checkbox"/> NO <input type="checkbox"/> Property use only
ITEM #						<input type="checkbox"/> OWNER <input type="checkbox"/> TKN FROM <input type="checkbox"/> CO-HAB	NAME ADDRESS DOB SS # OLN	YES <input type="checkbox"/> NO <input type="checkbox"/> YES <input type="checkbox"/> NO <input type="checkbox"/> Property use only
ITEM #						<input type="checkbox"/> OWNER <input type="checkbox"/> TKN FROM <input type="checkbox"/> CO-HAB	NAME ADDRESS DOB SS # OLN	YES <input type="checkbox"/> NO <input type="checkbox"/> YES <input type="checkbox"/> NO <input type="checkbox"/> Property use only
ITEM #						<input type="checkbox"/> OWNER <input type="checkbox"/> TKN FROM <input type="checkbox"/> CO-HAB	NAME ADDRESS DOB SS # OLN	YES <input type="checkbox"/> NO <input type="checkbox"/> YES <input type="checkbox"/> NO <input type="checkbox"/> Property use only

OFFICER [Signature] 0485 CITIZEN _____ DATE _____
 SIGNATURE AND BADGE NUMBER IF FIELD RECEIPT, HAVE CITIZEN SIGN

Report Number: 1994-24279

Please note that the records provided in this release do not include records or portions of records that are exempt from disclosure pursuant to applicable law. Without limiting other arguments against disclosure that may exist, the following records or portions of records are specifically prohibited or exempted from disclosure:

Records or information, the disclosure of which would compromise the anonymity of whistleblowers, complainants, victims or witnesses (Cal. Pen. Code § 832.7(b)(6)(B));

Records or information, the disclosure of which would reveal personal identifying information, where, on the facts of the particular case, the public interest served by not disclosing the information clearly outweighs the public interest served by disclosure of the information (Cal. Pen. Code § 832.7(b)(7));

Records or information wherein the public interest served by not disclosing the record clearly outweighs the public interest served by disclosure (Cal. Gov. Code § 7922.000);

Records or information that constitute confidential medical, financial, or other information, the disclosure of which is specifically prohibited by federal law or would cause an unwarranted invasion of personal privacy (Cal. Pen. Code § 832.7(b)(6)(C));

Records or information, the disclosure of which is exempted or prohibited pursuant to federal or state law (Cal. Gov. Code § 7927.705; see also Cal. Const. art. 1 Sec. 1).

Sacramento Police Department
Professional Standards Unit
916-808-3790
spdpus@pd.cityofsacramento.org